



morton.

Wentworth Point A10001/16 Amalfi Drive

 1  1  1

Promising a real sense of community as part of the popular One the Waterfront development, this well-proportioned one-bedroom apartment delivers a functional single-level design along with an elevated aspect and open park outlook. Its bright and airy layout has been well-planned to provide a low-maintenance and easy urban lifestyle with lots of natural light and a prime position.

- Fresh, breezy and bright interiors with a well-considered design
- Air-conditioned living and dining area
- Open balcony with park view
- A full gas-fitted kitchen with stone island bench and dishwasher
- Security car space, lift access and intercom entry
- Access to the Pulse Club swimming pools, gym and tennis courts

View

As advertised or by appointment

Agent

Nevena Tsahtarlis

 0428 835 910

 nevena@morton.com.au

morton.com.au

Internal Area Approx	65sqm
Car Space Area Approx	14sqm
Balcony Area Approx	10sqm
Storage Cage Area Approx	2sqm
Total Area Approx	91sqm

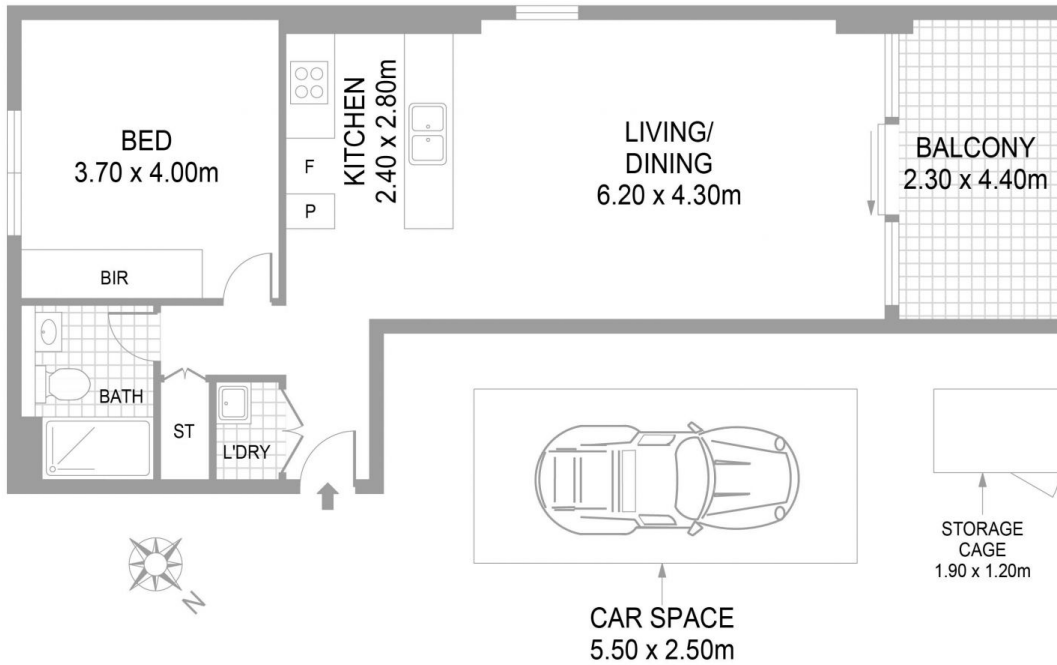

10001/16 AMALFI DR, WENTWORTH POINT

Disclaimer: Please note that while the information contained in this floor plan is provided by reliable sources, we cannot guarantee its accuracy. It is intended as a guide only. Interested parties should rely on their own enquiry. Drawing not to scale. Dimensions are approximate.

