



morton.

Wentworth Point 7/29 Bennelong Parkway

 4  2  2

The Waterfront is located moments to Sydney Olympic Park main venues, Bicentennial Park and Millennium Parklands. Located in Mariners Cove, this is your opportunity to move into this light-filled three bedroom apartment offers an amazing array of indoor and outdoor spaces. Only a short stroll from The Promenade and The Piazza, this property is a must to inspect.

- Brand new carpets, blinds and downlights throughout
- Open plan lounge dining area with direct balcony access
- Generous size ensuite with resort style bathtub with views of the water
- Four family size bedrooms
- Oversized entertainers balcony with absolute water views
- Enormous floorplan with house like proportions
- Two separate terraces with timber decking
- Fully fitted kitchen with quality appliances
- Bathroom with bath tub and internal laundry with dryer
- Split system air-conditioning unit and audio security intercom
- Double lock up garage (side by side)

morton.com.au

View

As advertised or by appointment

Agents

Zarin Hossain

 0418 328 479

 zarin.hossain@morton.com.au

Nevena Tsahtarlis

 0428 835 910

 nevena@morton.com.au



DISCLAIMER

NO RESPONSIBILITY TAKEN FOR INFORMATION PROVIDED HEREIN.
 INTERESTED PARTIES SHOULD RELY ON THEIR OWN ENQUIRIES
 AND THE CONTRACT FOR SALE. CARPARK AREAS NOT INCLUDED.
 REFER TO STRATA PLANS FOR ADDITIONAL INFORMATION.

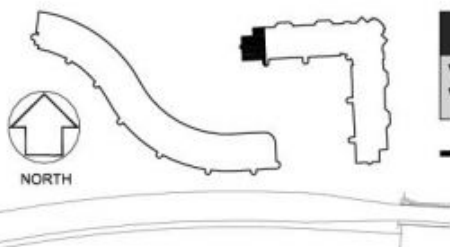

APARTMENT 7

3 BEDROOM + STUDY

INTERNAL AREA 130 sqm
 EXTERNAL AREA 39 sqm
 TOTAL AREA 169 sqm

MARINERS COVE

RESIDENTIAL APARTMENTS

29 Bennelong Road
 Homebush Bay