



# morton.

**Penrith** 504/60 Lord Sheffield Circuit

 2  2  1

Wildwood Apartments within Sheffield Quarter is a located on the north side of Penrith train station situated in the highly sought after master-planned community Thornton Estate. With uninterrupted park and district views, plus water views towards the picturesque Blue Mountains, offering convenient apartment living only metres to Penrith train station, Westfield shopping centre, local parks and quality restaurants and cafes.

This as new spacious two-bedroom apartments with the study is positioned on the west side of the building with a distinctive exterior façade, perched on level 5 overlooking the water canal with stunning views of the picturesque Blue Mountains.

- Large 80sqm internal light-filled open living and dining area
- Contemporary design, quality finishes w timber floorboards
- Split A/C, good sized study room, NBN ready, video intercom
- Gas kitchen w stone benchtops & stainless steel appliances
- Spacious Bathrooms with large mirrors and generous storage

[morton.com.au](http://morton.com.au)

### View

As advertised or by appointment

### Agent

**Raymond Huynh**

 0436 113 121

 [zetlandleasing@morton.com.au](mailto:zetlandleasing@morton.com.au)



# SHEFFIELD QUARTER

TRIDENTON

## TWO BEDROOM + STUDY APARTMENT

UNIT 2.04 LOT 26  
 UNIT 3.04 LOT 41  
 UNIT 4.04 LOT 56  
 UNIT 5.04 LOT 71

INTERNAL AREA:	80 m <sup>2</sup>
EXTERNAL AREA:	10 m <sup>2</sup>
TOTAL:	90 m <sup>2</sup>
PARKING:	1

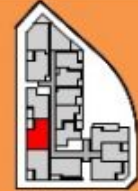

URBAN CBRE  
 REAL ESTATE



All apartments subject to contract and availability. Images showing the building, location and views are computer generated and do not constitute an offer. All dimensions, names, brands and specifications are subject to change and may differ from those shown. Views differ between apartments. Contact your agent for further information. Plans and drawings are for illustrative purposes and do not constitute an offer.