



# morton.

**Kingswood** 514/240-250 Great Western Highway

 2  2  1

A refined and functional two-bedroom unit in the esteemed "Kingswood Square," located on Level 5 with stunning views. This apartment boasts a prime position directly opposite Nepean Hospital and is within walking distance of Kingswood Station and Penrith CBD.

#### Feature

- Spacious and practical layout with high ceilings and downlights throughout
- Two good-sized bedrooms with hybrid flooring and mirrored wardrobes
- Two elegant bathrooms with high-end showers
- Stone benchtop kitchen with stainless steel appliances, including a gas stovetop
- Spacious living and dining area with tile flooring, opening up to a good-sized balcony
- Secure block with basement parking, NBN, and Foxtel-ready
- Ideally located across from Kingswood train station and the Great Western Highway
- Close to Nepean Hospital, Western Sydney University, and

#### View

As advertised or by appointment

#### Agent

**Jamie Bae**

 0409 968 604

 jamie.bae@morton.com.au

[morton.com.au](https://morton.com.au)



Size  
Internal + Balcony : 89sqm  
Total (carspace + storage): 106sqm

Outgoings  
Strata: \$1,050/q  
Council: \$448/q  
Water: \$170/q

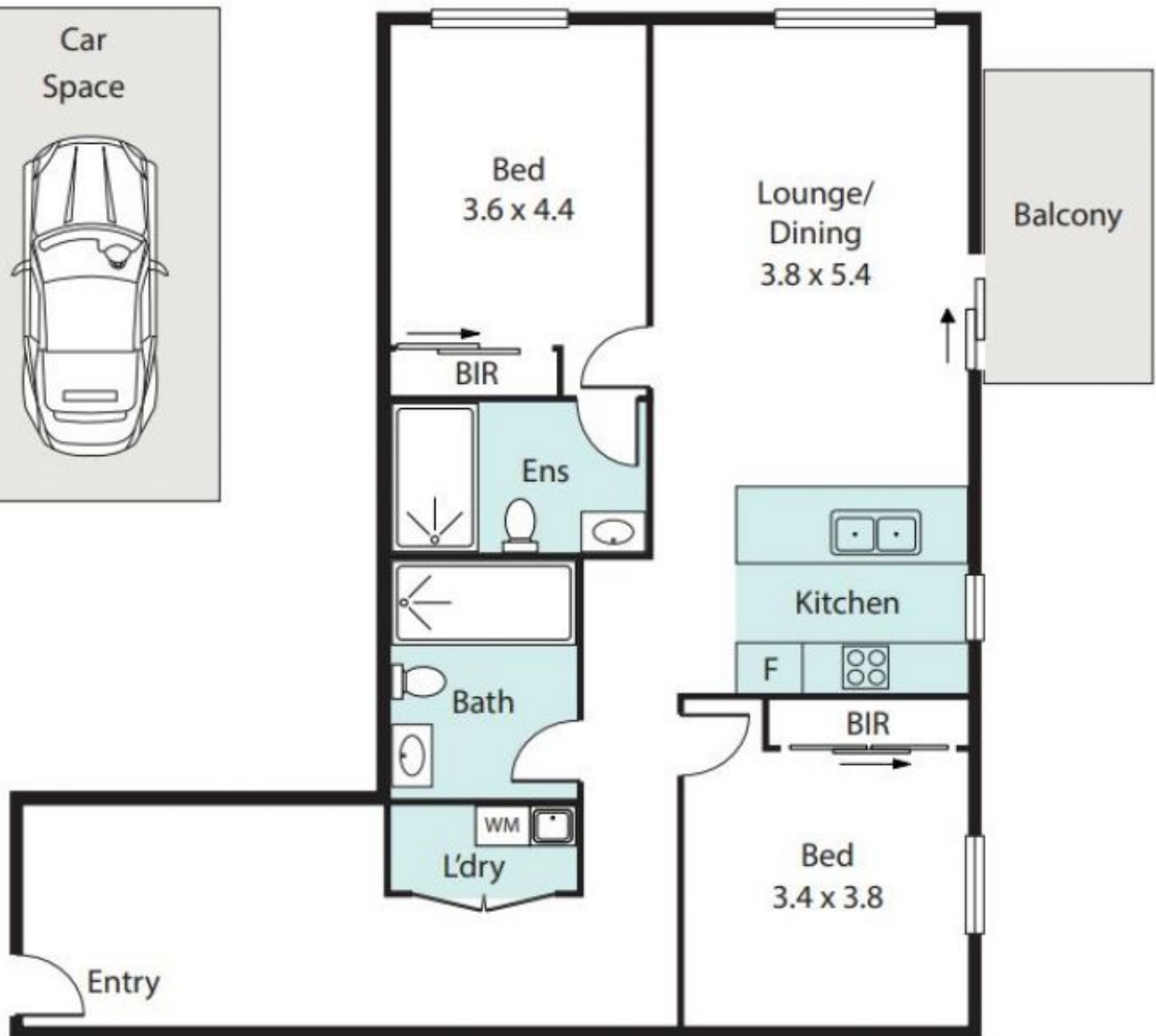
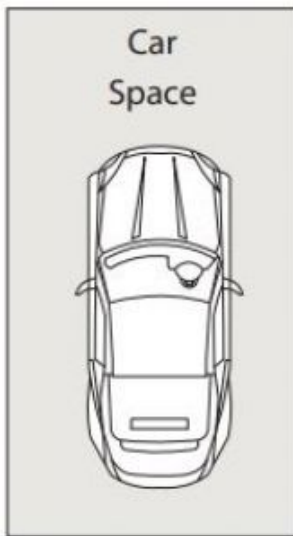

514/240-250 Great Western Highway, Kingswood



Every care has been taken to verify the accuracy of the details and dimensions in this property plan. Prospective purchasers are advised to make their own enquiries to satisfy themselves in all respects.