



morton.

Zetland 1310/8 Kingsborough Way

 2  2  1

This sun drenched two-bedroom residence creates an instant impact with its generous proportions, sleek designer finishes and surrounding facilities. It is set within a prestige architectural complex and offers a quality lifestyle property that has all the amenities of Victoria Park, East Village and Green Square station a stroll from the front door.



- Bright open-plan design featuring living and dining areas
- Private balcony with views
- Double bedrooms with built-in robes and access to balcony
- Designer kitchen with dishwasher and gas appliances
- Fresh modern decor and easy-to-maintain
- A large designer bathroom plus an internal laundry
- Car space
- Storage Cage

View



As advertised or by appointment

Agents

Calvin Chan

 0406 888 028
 calvin@morton.com.au

Jackson Figueiras

 0448 764 345
 jackson@morton.com.au

morton.com.au

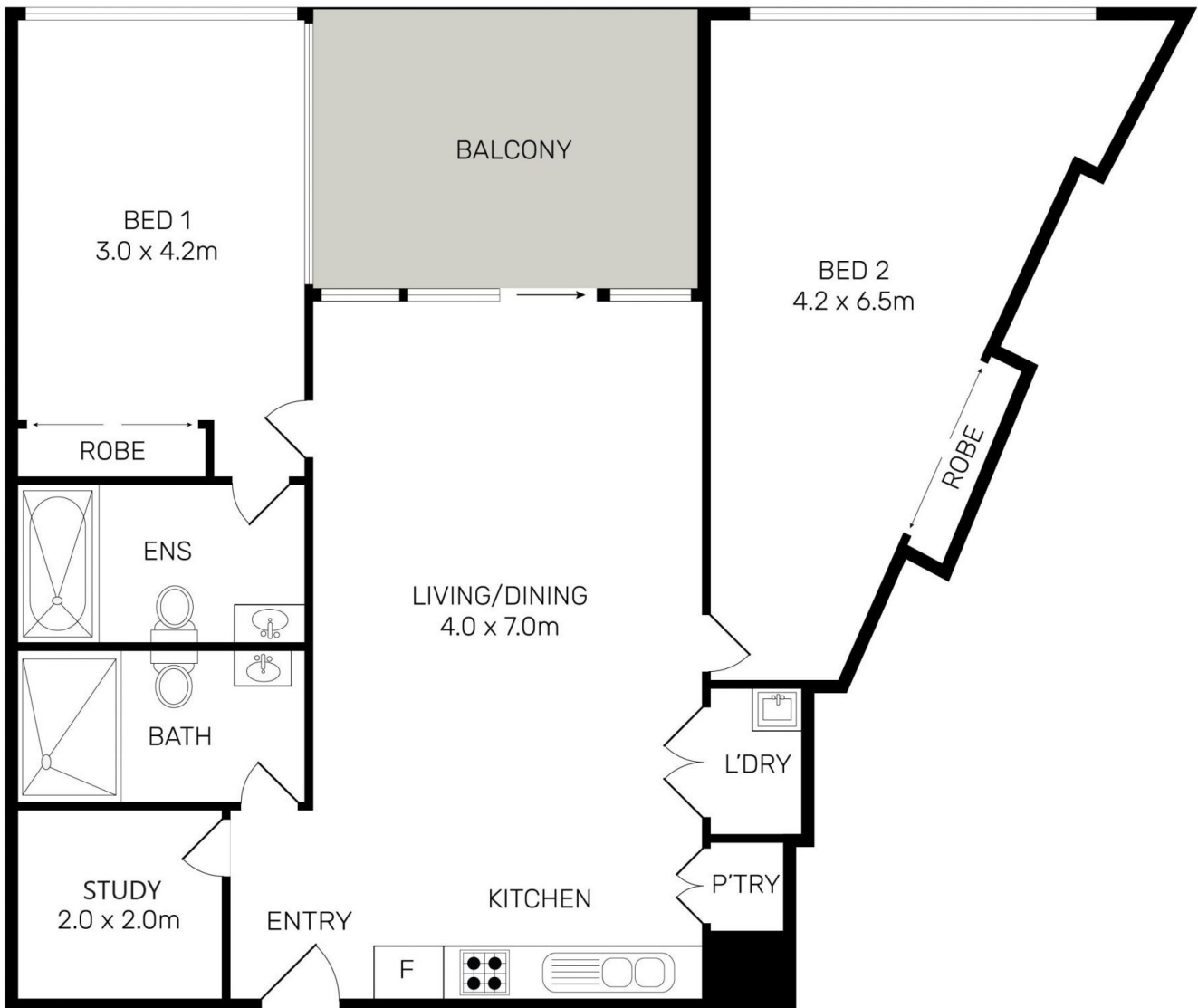
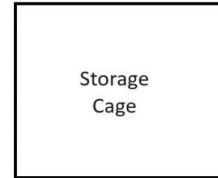
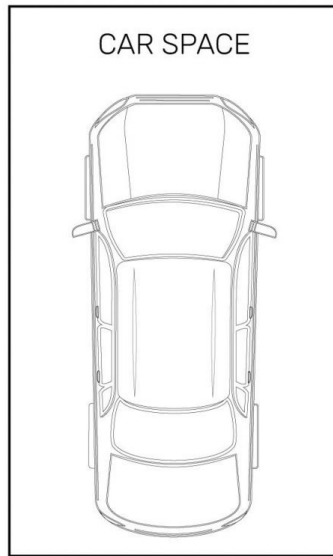

All information contained herein is gathered from all sources we believe to be reliable. However we cannot guarantee its accuracy and interested parties should rely on their own enquiries.



1310/8 Kingsborough Way, Zetland