



morton.

Ashfield 601/268-270 Liverpool Road

 2  1  1

Situated in the vibrant heart of Ashfield, this stunning near-new development boasts a sun-drenched top-floor apartment offering expansive, north-facing district views and privacy. Melding sophisticated urban living with impeccable finishes, the design is both stylish and functional.

- Spacious designer bedroom complete with built-in wardrobe
- Double facing layout, cross ventilation, situated on level 6
- Positioned quietly and discreetly behind Liverpool Road
- Open-plan living/dining area features oak timber floorboards
- High-quality finishes enhance the stunning outlook
- Generous multi-purpose room/study/potential second bedroom
- Modern kitchen with high-quality reconstituted stone benchtop
- Stainless steel cooktop, oven, and dishwasher
- Sleek bathroom with internal laundry facilities
- Ducted air conditioning ensures year-round comfort
- Secure car space and additional storage cage

View

As advertised or by appointment

Agents

Ian Qiu

 0447 696 425
 ian@morton.com.au

Akanksha Chaudhari

 0447 201 786
 akanksha.chaudhari@morton.com.au

morton.com.au

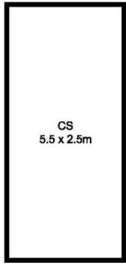

Not In Position

