



morton.

Woolloomooloo 129/6 Cowper Wharf Roadway

 1  1  1

Located in the heritage listed Finger Wharf is this quality one bedroom apartment with an impressive out door 33sqm entertaining deck. This apartment boasts expansive water views and looks towards Potts Point and is only a short stroll to the local eateries and entertainment.

- Recently renovated carpet
- Direct Wharf access from your deck
- Generous sized living and entertaining
- Large granite kitchen with Blanco fittings
- Good sized master bedroom with built-ins
- Internal laundry with dryer
- White good included
- Walk through Botanical Gardens to the city
- Security parking located at Lincoln Cres and 24 hour onsite security

View

As advertised or by appointment

Agent

Reza Nabavi

 0419 283 588

 reza.nabavi@morton.com.au

morton.com.au

129/6 Cowper Wharf Road,
WOOLLOOMOOLOO

SCALE 

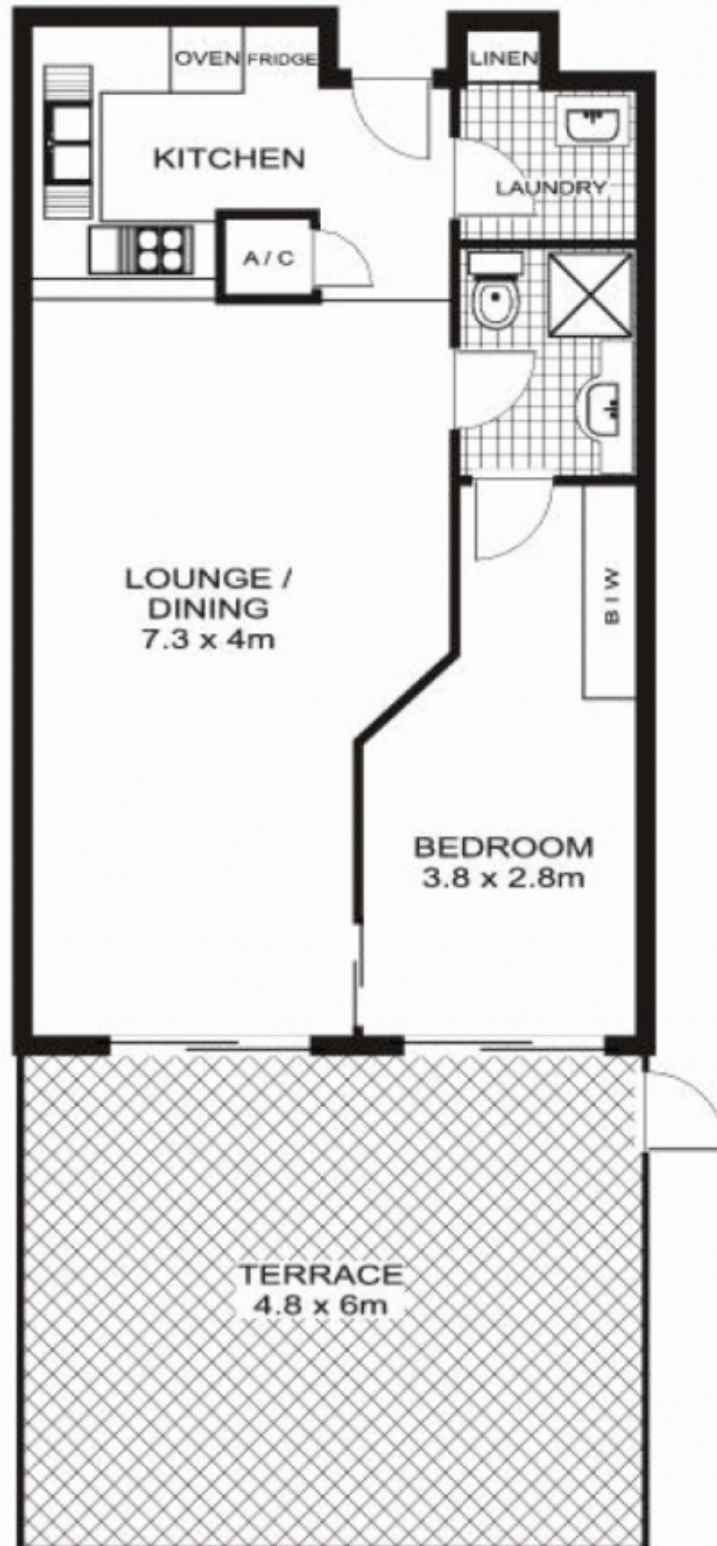

* note
all measurements are approximate only.
Plan is provided only as an indication of layout.