



# morton.

**Ermington** 310/70 River Road

 2  2  1

Located in the new urban hub of Royal Shores, San Marco offers lifestyle apartment living within the masterplanned community in Ermington. Perched on the waters edge, San Marco offers easy access to the river, cycleway and parks.

#### APARTMENT FEATURES

- Reverse cycle air conditioning
- Stainless steel kitchen appliances
- Stone bench tops, mirror splash backs
- LED under cupboard lighting
- Wool blend carpets, efficient LED down lights
- Data/TV points in living and main bedroom
- Recessed mirrored cabinets in bathroom
- Security building, video intercom

#### NEIGHBORHOOD FACILITIES

- Woolworths, Liqourland, Bakery 900m away
- Local bus routes (523, 524, 525 600m-1.5km away)
- West Ryde Railway station 4.2kms away
- Rydalmere Ferry Wharf 1.2 km away

#### View

As advertised or by appointment

#### Agents

##### Zarin Hossain

 0418 328 479

 [zarin.hossain@morton.com.au](mailto:zarin.hossain@morton.com.au)

##### Nevena Tsahtarlis

 0428 835 910

 [nevena@morton.com.au](mailto:nevena@morton.com.au)

[morton.com.au](http://morton.com.au)



**SEAMIST**

**APARTMENT 325  
LOT 154**

2 BEDROOM

Internal (including Winter Garden)	90 sqm
<b>Total</b>	<b>90 sqm</b>

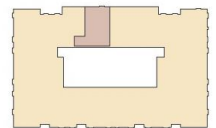

SEAMIST - LEVEL 3

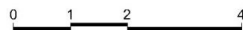

Disclaimer: This floor plan has been prepared for marketing purposes only. All descriptions, dimensions, depictions and other details in this floor plan may not be to scale and may vary from the property as built. Your attention is drawn to the special conditions of the contract for sale of land. No third party has any authority to make or give any representation or warranty in relation to the property unless the representation or warranty is confirmed by the vendors and included in the contract for sale of land. Date Issued: 03/10/14 Revision: A