



morton.

Chippendale 5/14-16 O'Connor Street

1 1 1

Located in Chippendale's finest Warehouse Conversion, "The Benedict", this oversized one bedroom residence fuses industrial charm and contemporary style. A secluded and highly-sought location, you are just moments from the vibrant buzz of Chippendale, Central Park and Broadway Shopping Centre.

- North facing, high ceilings, clean and bright interiors throughout
- Modern kitchen, stainless steel appliances, gas cooking & dishwasher
- Good-sized loft style bedroom and built-in wardrobe
- Open plan living & dining area leading to balcony
- Alfresco balcony with venetian shutters
- Security intercom & security building
- Full internal laundry & storage throughout, air-conditioning
- Underground parking space with attached storage cage
- Communal rooftop area with city views

Auction

Tuesday, 16 Jul 2024, 6:00 pm

View

As advertised or by appointment

Agents

Ian Qiu

0447 696 425

ian@morton.com.au

Naomie Texier

0439 247 710

naomie@morton.com.au

morton.com.au

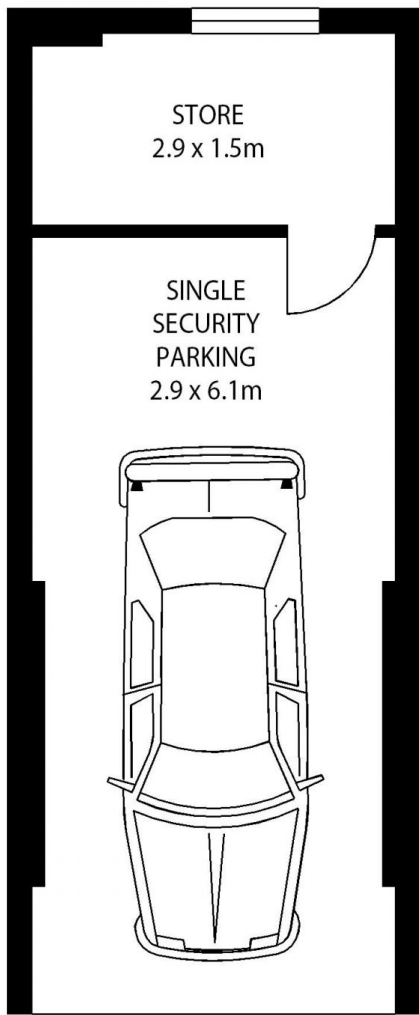

BASEMENT

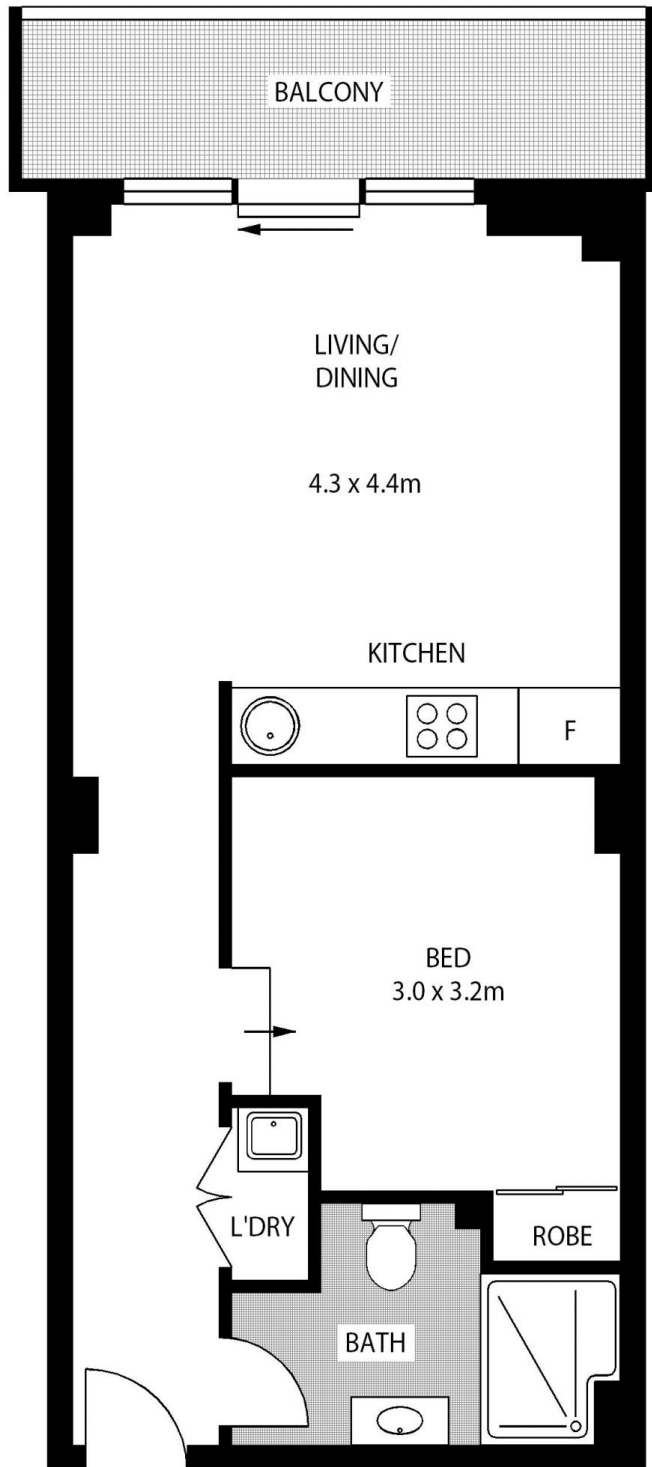

LEVEL 1



5/14-16 O'CONNOR STREET

CHIPPENDALE