



morton.

Wentworth Point 846/1E Burroway Road

2
 2
 1

Jewel is the iconic gateway that connects the Sydney Harbour to Wentworth Point. Ideally positioned at the northern tip of the peninsular, Jewel sits atop transport links including the Sydney Olympic Park ferry wharf and bus terminals, and the Pierside retail precinct that includes restaurants, health and beauty care, while only footsteps away is Marina Square shopping complex and Wentworth Point Public School. This enviably appointed apartment commands a private north-facing corner positioning and exclusive uninterrupted water views, and showcases a spacious and boastfully lit haven.

- Absolute waterfront 8th floor apartment with glistening river views
- First class finishes throughout
- Unique floorplan with luxury tiles in the open living space
- State of the art chef's kitchen with stone benchtops, integrated appliances soft closing cupboards
- Perfect for entertaining oversized north-facing balcony
- Alfresco kitchen with premium finishes and stone benchtop

View

As advertised or by appointment

Agents

Zarin Hossain

0418 328 479
 zarin.hossain@morton.com.au

Nevena Tsahtarlis

0428 835 910
 nevena@morton.com.au

morton.com.au



0 1 2 4m



JOINTLY DEVELOPED BY



Disclaimer: This floor plan has been prepared for marketing purposes only. All descriptions, dimensions, depictions and other details in this floor plan may not be to scale and may vary from the property as built. Your attention is drawn to the special conditions of the contract for sale of land. No third party has any authority to make or give any representation or warranty in relation to the property unless the representation or warranty is confirmed by Payce Communities Wentworth Point Pty Ltd, SEI FWT Development Pty Ltd and included in the contract for sale of land. SCOA Disclaimer: In this disclaimer Developer means Payce Communities Wentworth Point Pty Ltd ACN 60 430 748 and SEI FWT Development Pty Ltd ACN 64 38 145. Development means the retail and residential development at Burroway Road Wentworth Point known as Jewel. SCOA means Sydney Olympic Park Authority a statutory body constituted under the Sydney Olympic Park Authority Act 2002 (NSW). The Developer is responsible for all matters in connection with undertaking and completing all of the works required to be performed or carried out to complete the Development and SCOA has no responsibility or involvement in those matters.

(Rev G_01.06.15)

SALES BY



JEWEL
WENTWORTH POINT

APARTMENT
846
LOT 242
2BED + STUDY

Internal	88 sqm
External	47 sqm
Total	135 sqm

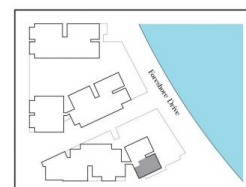

LEVEL 8

JEWEL DISPLAY CENTRE
1 Burroway Road, Wentworth Point 2127
♦ 1300 888 778 ♦ jewelresidences.com.au