



morton.

Riverwood 421/7 Washington Avenue

 2  2  1

Showcasing a sleek, contemporary design, this modern security apartment epitomizes low-maintenance living with its quality finishes, spacious layout, and prime lifestyle location. Ideal for city professionals and a lucrative investment opportunity, it boasts convenient access to a variety of shopping, dining, and transport options just a short stroll from your doorstep.

Features:

- ? Generous open-plan layout
- ? 2 Spacious bedrooms with built-in robes
- ? Gas cooking kitchen with stone countertops
- ? Contemporary bathrooms with ensuite via master room
- ? European laundry, air-conditioning, intercom access
- ? Security complex with lift access to basement and apartment
- ? Single car space plus a lockable storage cage
- ? Set in the sought-after 'Washington Park' community
- ? Close proximity to shops, transport & M5 motorways

This residence offers a prime location with excellent access to

morton.com.au

View

As advertised or by appointment

Agent

Nada Fayad

 0408 376 995

 nadaf@morton.com.au



**APARTMENT 421
LOT 177
2 BED + STUDY**

Internal	78sqm
External	7sqm
Total	85sqm

COMO

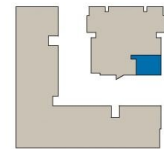

1300 111 088
www.washingtonpark.com.au

Proudly developed by
PAYCE

Disclaimer: This floor plan has been prepared for marketing purposes only. All descriptions, dimensions, depictions and other details in this floor plan may not be to scale and may vary from the property as built. Your attention is drawn to the special conditions of the contract for sale of land. No third party has any authority to make or give any representation or warranty in relation to the property unless the representation or warranty is confirmed by Payce Communities No.1 Pty Limited and included in the contract for sale of land. [Rev A 13.05.13]

**We are
Washington Park.**