



# morton.

Westmead 42/17B Booth Street

1 2 1

Great opportunity to lease one of many units in the Asha development in Westmead. This development is perfectly positioned just minutes away from Parramatta CBD with easy access to transport, schools, Westfield shopping centre and Parramatta Park.

- Generous open plan design with fresh modern décor plus study room
- Beautiful designer kitchen
- Timber flooring throughout living area plus ample storage
- Bathroom has floor to ceiling tiles, mirrored vanity cabinet
- Spacious bedroom with built-in robe, abundance of natural light
- Entertainer's balcony
- Intercom, laundry with dryer, air-conditioning
- Separate laundry room
- Secure car park and storage cage in basement
- Oversized study bedroom with ducted A/C, window, and door
- perfect for a home office or small second bedroom

### View

As advertised or by appointment

### Agents

#### Zarin Hossain

0418 328 479

zarin.hossain@morton.com.au

#### Nevena Tsahtarlis

0428 835 910

nevena@morton.com.au

[morton.com.au](http://morton.com.au)

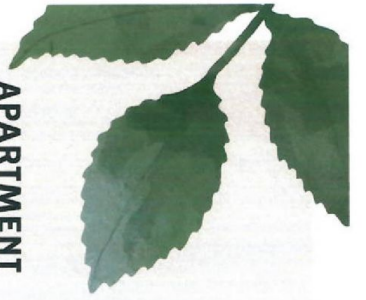

# APARTMENT

# 42

BEDROOMS	02
BATHROOMS	02
INTERNAL	75m <sup>2</sup>
EXTERNAL	10m <sup>2</sup>
TOTAL AREA	85m <sup>2</sup>

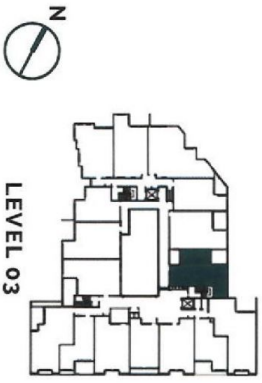

Disclaimer: The provided information is set out as a general guide to reflect the developer's current intentions. All information is believed to be correct at the time of campaign development and is subject to C.C. All intending purchasers should seek their own legal advice. Furniture items are not included.