



morton.

Zetland 541/2C Defries Avenue

🛏 1 🚿 1 🚗 1

Sold by Calvin Chan 0406 888 028

Designed for stylish and convenient living this beautifully presented one bedroom apartment is located within Victoria Park's coveted East Village, enjoying immediate access to a unique sky park and vibrant retail and dining precinct below. Built in 2014 by developers PAYCE and designed by Turner + Associates, the apartment blends high quality finishes with functional spaces and is perfect for tenacious investors or owner occupiers.

- Peaceful all-weather balcony with metropolitan views
- Large study area/home office
- Open plan lounge and dining with polished tiled floors
- Integrated kitchen with granite bench tops and stainless steel appliances
- Spacious double bedroom with walk-in robe and balcony access
- Deluxe designer bathroom and Internal laundry
- Air-conditioning; Secure intercom entry with lift access

morton.com.au

View

As advertised or by appointment

Agents

Calvin Chan

📞 0406 888 028
✉ calvin@morton.com.au

Jackson Figueiras

📞 0448 764 345
✉ jackson@morton.com.au

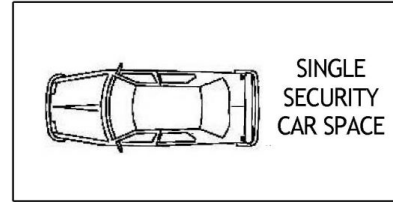
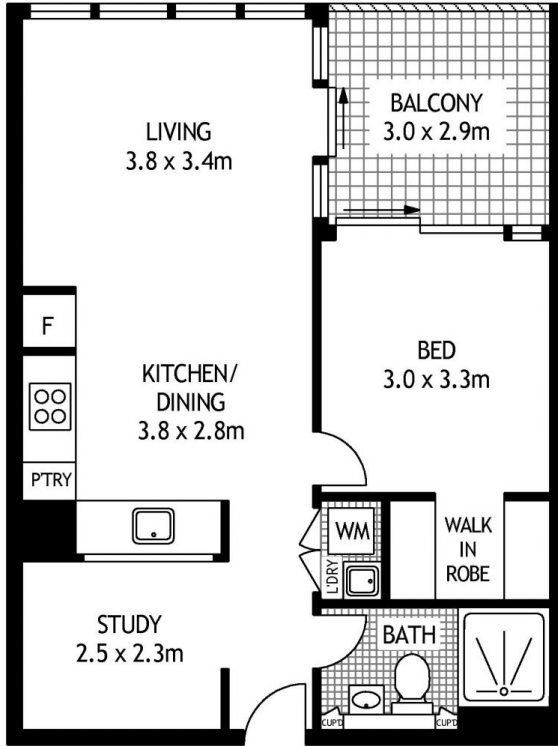

ENTRY
LEVEL FIVE

541/2C DEFRIES AVENUE

ZETLAND

SCAPE Floor Planning Disclaimer: This floor plan is conceptual only. It is provided for illustrative purposes only and should not be relied upon. We make no guarantees to the correctness of this plan. All interested parties should make and rely on their own enquiries in determining the accuracy of the information contained in this floor plan.