



morton.

Riverwood Level 2/213/7 Washington Avenue

 1  1  2

Indulge in the allure of urban living with this stylish one-bedroom plus large study unit nestled in the building "Como". Boasting dual balconies, this residence offers an abundance of outdoor space to enjoy the surrounding views, lake, park, and fresh air. Adding to its appeal, this unit features a rare double car space, providing ample parking convenience.

- Dual balconies overlooking the garden and street
- Convenient parking for two vehicles
- Spacious study area for work or hobbies
- Bedroom with built-in robe with ample storage
- European style laundry with dryer for added convenience
- Air conditioning for comfort in all seasons
- Extra Large storage room in basement

View

As advertised or by appointment

Agent

Nada Fayad

 0408 376 995

 nadaf@morton.com.au

morton.com.au



**APARTMENT 213
LOT 39
1BED + STUDY**

Internal	65sqm
External	21sqm
Total	86sqm

COMO

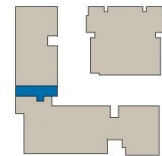

1300 111 088
www.washingtonpark.com.au



Disclaimer: This floor plan has been prepared for marketing purposes only. All descriptions, dimensions, depictions and other details in this floor plan may not be to scale and may vary from the property as built. Your attention is drawn to the special conditions of the contract for sale of land. No third party has any authority to make or give any representation or warranty in relation to the property unless the representation or warranty is confirmed by Payce Communities No.1 Pty Limited and included in the contract for sale of land. [Rev A 13.05.13]

