



morton.

Penrith 706/10 Aviators Way

🛏 1 🚿 1 🚗 1

Situated in what is without a doubt Penrith's premiere estate, this one bedroom, north east facing unit has brilliant views over the oval and surrounding area. Looking towards the Blue Mountains and capturing the morning sun as it rises from the east, this apartment is sure to impress.

- Northeast facing and perfectly positioned on level 7
- Split system air con throughout the apartment with blinds
- Kitchen island bench with 4 burner gas cooktop and Omega appliances
- Floorboards in the kitchen and living with carpet to the bedroom
- Generous 64sqm of internal and external living area
- Secured basement car space and storage cage
- NBN ready and pet friendly with 2 lifts to the building
- On-site building manager, community BBQ and playgrounds at your doorstep

View

As advertised or by appointment

Agent

Anthony Fleming

📞 0437 929 484

✉ anthonyf@morton.com.au

morton.com.au



**BASEMENT 2
NO.89**

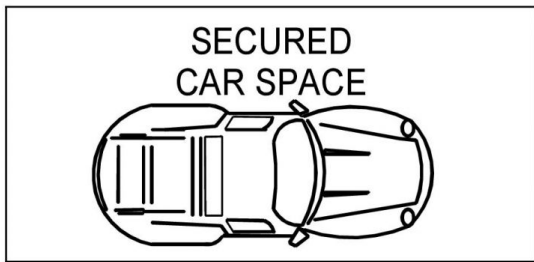

**BASEMENT 2
NO.94**

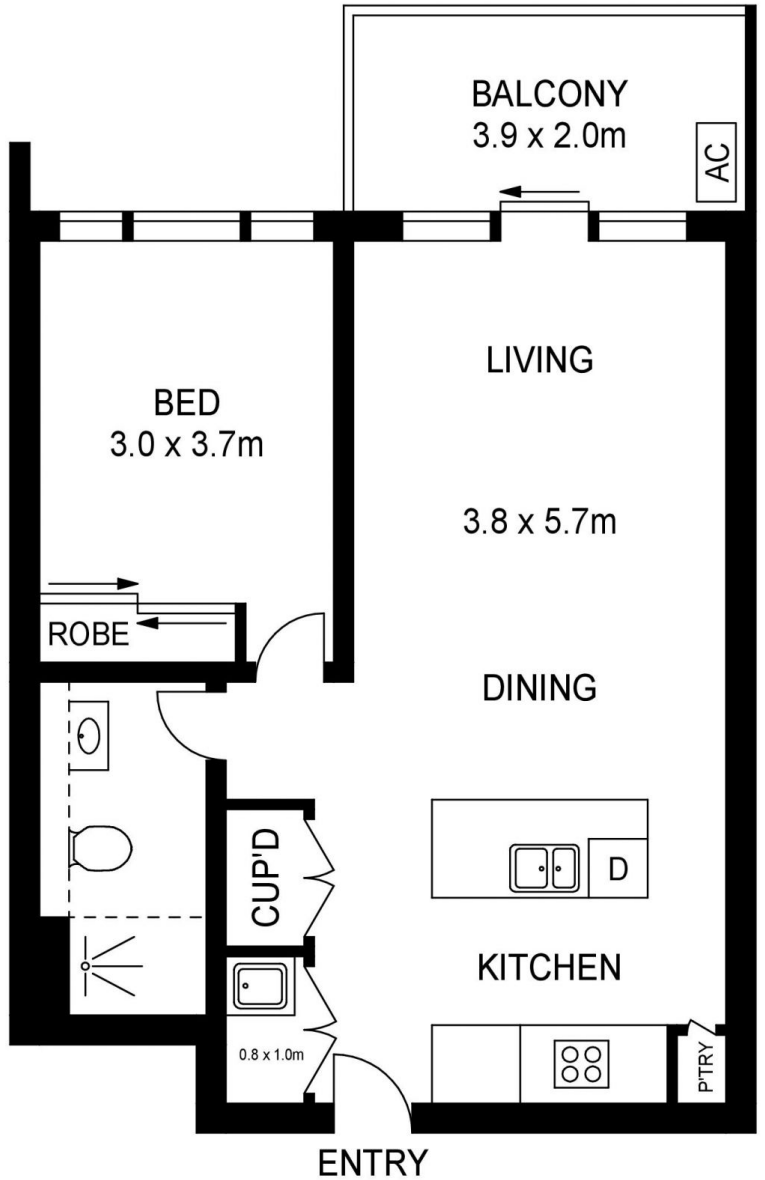

LEVEL SEVEN

APPROX. INT. AREA : 56m²
 APPROX. EXT. AREA : 8m²
 TOTAL AREA INCLUDING
 CAR SPACE AND STORAGE CAGE : 79m²

706/10 AVIATORS WAY, PENRITH



www.assetphotographers.com.au

Please note these measurements are approximate only. The plans is intended as a rough guide for illustrative purpose. It is not warranted or guaranteed to be correct nor it is part of the sale or rental contract

