



morton.

Wentworth Point 904/4 Footbridge Boulevard



Located in the vibrant Waterfront Estate, Quarterdeck by Billbergia is sophisticated urban living at its best. Quarterdeck is a waterfront development surrounding a beautifully landscaped garden, boasting ecologically sustainable design. The apartment features a versatile entertainer's winter garden overlooking parklands, solar tinted double glazed floor to ceiling glass, and air conditioning throughout living and bed quarters. Perfectly located just footsteps from Wentworth Point's Marina Square shopping precinct, Sydney Olympic Park ferry wharf, and public transport at your doorstep, this sleek abode offers the ideal home for the modern lifestyle.

- Superb natural light from its north facing aspect
- Open living and dining flowing to spacious versatile winter garden
- Winter garden spanning end to end with openable louvres for ventilation and versatile function
- Full kitchen with polished stone bench tops and premium appliances
- Generously sized bedroom with built-in wardrobe

morton.com.au

View

As advertised or by appointment

Agents

Zarin Hossain

📞 0418 328 479

✉️ zarin.hossain@morton.com.au

Nevena Tsahtarlis

📞 0428 835 910

✉️ nevena@morton.com.au

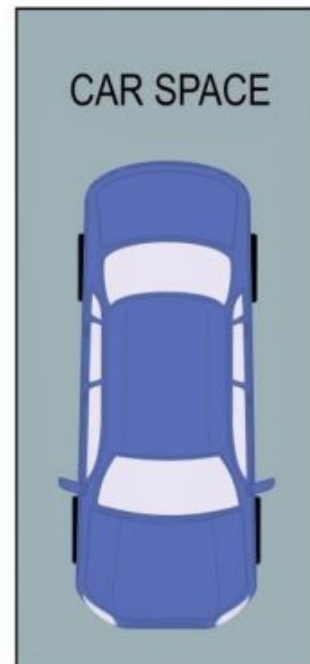
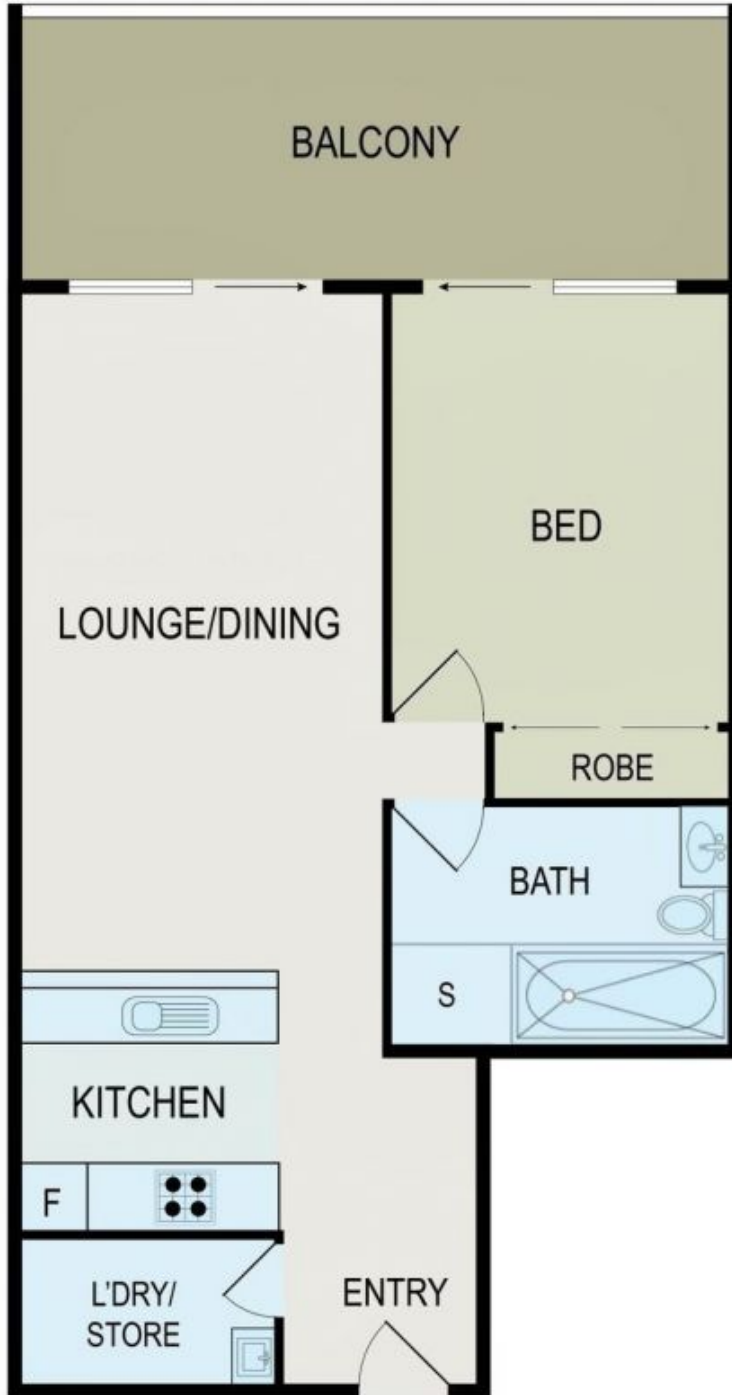

All information contained herein is gathered from all sources we believe to be reliable. However we cannot guarantee its accuracy and interested parties should rely on their own enquiries.

