



# morton.

**Wentworth Point** 182/33 Hill Road

 2  2  1

The Waterfront is located moments to Sydney Olympic Park main venues, train station, Bicentennial Park and Millennium Parklands. Located in Palermo, this is your opportunity to move into this two bedroom apartment with courtyard, only a short stroll from The Promenade and The Piazza.

- Located on level one with courtyard
- Combined living and dining room
- Reverse cycle air conditioning
- Full size kitchen with stainless steel appliances
- Gas cooking and lots of cupboard space
- Great size bedroom with huge built-in wardrobes
- Laundry room with clothes dryer
- Secure undercover single car space and storage cage
- Palermo building includes exclusive pool and gym

### View

As advertised or by appointment

### Agents

#### Zarin Hossain

 0418 328 479

 [zarin.hossain@morton.com.au](mailto:zarin.hossain@morton.com.au)

#### Nevena Tsahtarlis

 0428 835 910

 [nevena@morton.com.au](mailto:nevena@morton.com.au)

[morton.com.au](http://morton.com.au)



ENTRY	1
LIVING	2
DINING	3
KITCHEN	4
MAIN BEDROOM	5
ENSUITE	6
LAUNDRY	7
BATHROOM	8
STUDY	9
LINEN	10
BEDROOM 2	11
TERRACE	12
CLOTHES DRYING	13

LEVEL 01

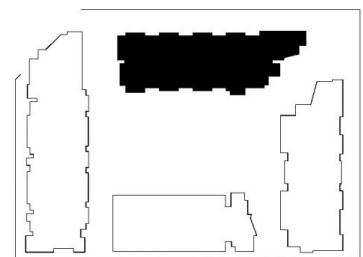

# PALERMO

UNIT: **182**

TYPE: 2 Bedroom

UNIT AREA: 92.0 sqm

OUTDOOR AREA: 105.0 sqm



Disclaimer: All layouts are indicative only, and subject to change.

