



morton.

Erskineville 1005/1 Metters Street

 1  1

Entrance to the property located on 1 Metters Street, Erskineville

The opportunity to live in one of the most charming and connected villages in the Inner West. This delightful designer 1 bed apartment offers exceptional living, an ideal aspect within a truly inspirational setting. Created by award-winning architects DKO, Sugarcube Apartments are amongst the most desirable residences ever to grace Erskineville's leafy village streets. Only three kilometers to the CBD and just two train stops to Central Station; you can cycle, train, bus or walk to the near-by universities, the City, schools, cafes, Newtown and Enmore in moments.

- Light-filled, open plan living
- Quality Miele appliances and gas cooktop
- Modern finishes and fittings
- Internal laundry with dryer
- Bedroom with large built-in wardrobes
- Beautifully landscaped rooftop garden

morton.com.au

View

As advertised or by appointment

Agent

Kristian Karaspyros

 0436 477 102

 kristian.karaspyros@morton.com.au

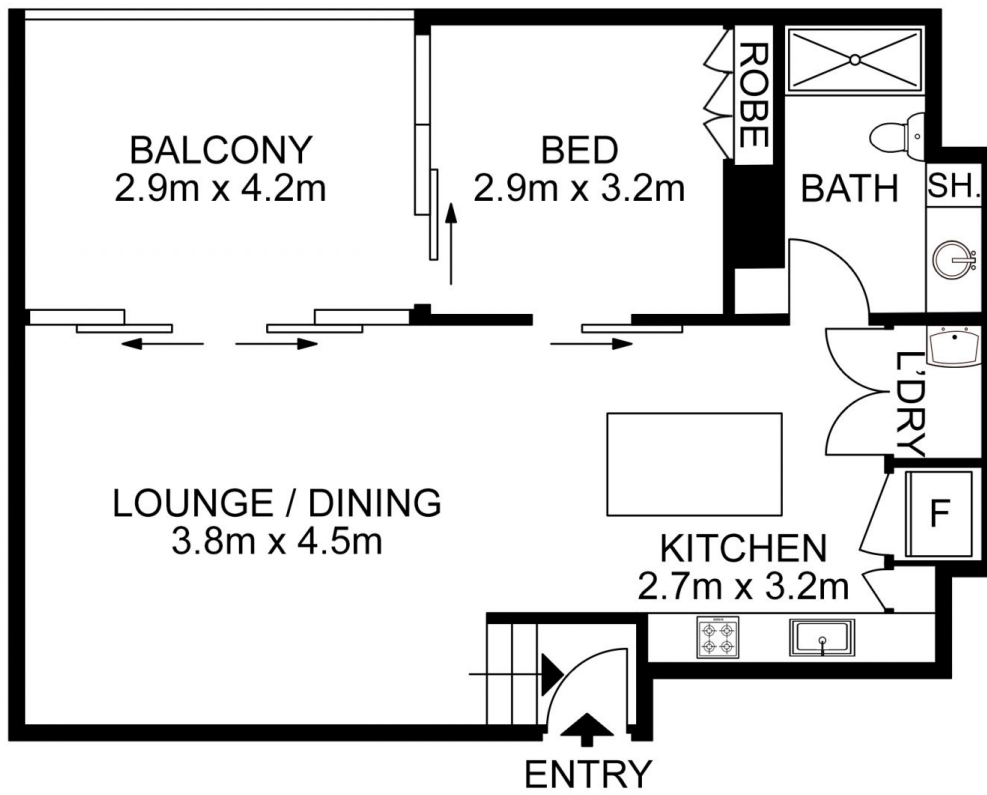

All information contained herein is gathered from all sources we believe to be reliable. However we cannot guarantee its accuracy and interested parties should rely on their own enquiries.

