



morton.

Wentworth Point 624/1 Burroway Road

 1  1  1

Jewel is the iconic gateway that connects the Sydney Harbour to Wentworth Point. Ideally positioned at the northern tip of the peninsular, Jewel is opposite to the ferry wharf, bus stops and rests above the Pierside retail precinct that includes restaurants, health care and beauty.

- Gourmet kitchen with quality appliances
- Timber look ceramic floor tiles
- LED lighting, split system reverse cycle air conditioning
- Open living and dining area
- Generous study room
- Lounge room with gas point and MATV and payTV points
- Internal laundry with dryer
- Audio intercom, secure access and lift
- Bathroom with ceramic wall and floor tiles, mirrored vanity cabinet
- Secure car space
- Covered balcony with water views
- On-site building manager, common landscaped courtyard

View

As advertised or by appointment

Agent

Sarah Fowell

 0437 492 129

 rentals@morton.com.au

morton.com.au

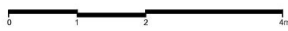
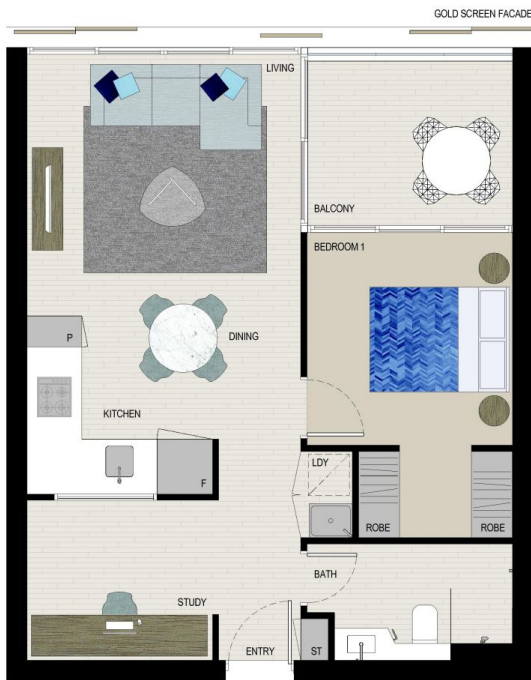

JOINTLY DEVELOPED BY



Disclaimer: This floor plan has been prepared for marketing purposes only. All descriptions, dimensions, depictions and other details in this floor plan may not be to scale and may vary from the property as built. Your attention is drawn to the special conditions of the contract for sale of land. No third party has any authority to make or give any representation or warranty in relation to the property unless the representation or warranty is confirmed by Payce Communities Wentworth Point Pty Ltd or FWT Development Pty Ltd and included in the contract for sale of land. SCDA Disclaimer: In this disclaimer Development means Payce Communities Wentworth Point Pty Ltd ACN 604 820 746 and SA FWT Development Pty Ltd ACN 164 281 145. Development means the retail and residential development at Burroway Road Wentworth Point known as Jewel. SCDA means Sydney Olympic Park Authority a statutory body constituted under the Sydney Olympic Park Authority Act 2005 (NSW). The Developer is responsible for all matters in connection with undertaking and completing all of the works required to be performed or carried out to complete the Development and SCDA has no responsibility or involvement in those matters.

SALES BY



(Rev C_01/06/15)



JEWEL

WENTWORTH POINT

APARTMENT 624

LOT 124
1BED + STUDY

Internal	54 sqm
External	7 sqm
Total	61 sqm

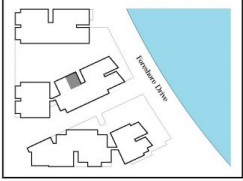

LEVEL 6

JEWEL DISPLAY CENTRE
1 Burroway Road, Wentworth Point 2127

◆ 1300 888 778 ◆ jewelresidences.com.au