



**morton.**

**Wentworth Point** 413/18 Corniche Drive

 2  2  2

Situated in Catania at The Waterfront, here is your opportunity to move into this spacious two bedroom apartment occupying a corner position with an L-shaped north-west facing entertainer's balcony. Only a stroll from The Promenade and The Piazza's local restaurants, convenience and pharmacy stores. It's central location offers prime access to public transport links off Hill Road and ferry service to Parramatta and Sydney CBD, while Wentworth Point's public school, Marina Square and Pierside retail complexes are just moments away.

- Sunny corner apartment with huge entertainers balcony
- Open plan combined living and dining
- Double galley kitchen with designer stainless steel appliances and gas cooking
- Generous size bedrooms with built-in wardrobes
- Main bathroom with bathtub, master bedroom with en-suite
- Study nook ideal for home office
- Internal laundry with clothes dryer
- Reverse cycle air conditioning

**morton.com.au**

**View**

As advertised or by appointment

**Agent**

**Sarah Fowell**

 0437 492 129

 rentals@morton.com.au

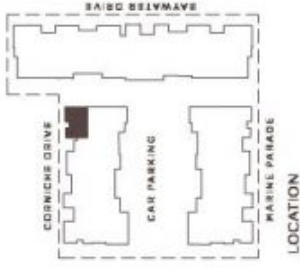

LOCATION

## UNIT 413 2 BEDROOM

INTERNAL 91 sqm  
BALCONY 28 sqm  
TOTAL AREA 119 sqm

KEY:

- 1 Entry
- 2 Living
- 3 Dining
- 4 Kitchen
- 5 Bedroom 1
- 6 Bedroom 2
- 7 Wardrobe
- 8 Study
- 9 Bathroom
- 10 Ensuite
- 11 Laundry
- 12 Store
- 13 Balcony



REV. D



Disclaimer: The purchaser should use this plan as a general guide to the proposed building structure and do not rely on it as a contract. All descriptions, dimensions, references to architects and necessary particulars for use and other details are given in good faith and are believed to be correct, but any intending purchaser should not rely on them as statements or representations of fact, but must satisfy themselves as to the correctness of all facts, and where necessary seek advice. No third party responsible for their report, but any authority to make as per any representation or warranty in relation to this property.  
\* External areas may be subject to development opportunities, refer to the site plan and site plan.