



morton.

Wentworth Point 564/3 Baywater Drive

 2  2  1

The Waterfront is located moments to Sydney Olympic Park main venues, train station, Bicentennial Park and Millennium Parklands. Located in Palermo, this is your opportunity to move into this two bedroom apartment, only a short stroll from The Promenade and The Piazza.

- Located on level five
- Spacious floorplan with combined open plan living and dining
- Reverse cycle air conditioning in lounge and room
- Full size kitchen with stainless steel appliances
- Gas cooking and lots of cupboard space
- Great size bedrooms with huge built-in wardrobes
- Laundry room with clothes dryer
- Secure undercover one car space and storage cage
- NBN and Foxtel outlets ready for account connection
- Palermo building includes exclusive pool and gym

View

As advertised or by appointment

Agent

Sarah Fowell

 0437 492 129

 rentals@morton.com.au

morton.com.au



- ENTRY 1
- LIVING 2
- DINING 3
- KITCHEN 4
- MAIN BEDROOM 5
- BATHROOM 6
- BEDROOM 2 7
- ENSUITE 8
- LAUNDRY 9
- LINEN 10
- BALCONY 11
- CLOTHES DRYING 12

LEVEL 05

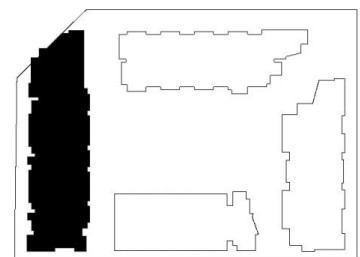

PALERMO

UNIT: **564**

TYPE: 2 Bedroom

UNIT AREA: 106.0 sqm

OUTDOOR AREA: 23.0 sqm



Disclaimer: All layouts are indicative only, and subject to change.



0 2.5 5M