



**morton.**

**WOOLLOOMOOLOO** 130/6 Cowper Wharf Road

1 1 1

\*\*\*Inspection times are available. To be notified of the inspection times via email or SMS (free of charge), simply submit an enquiry here with your contact details. Alternatively please search for the listing on our website <http://www.mortonandmorton.com.au> to book your own inspection online.\*\*\*

**View**

As advertised or by appointment

**Agent**

**Morton**



info@morton.com.au

A unique opportunity to secure a sought after level one terrace apartment at the renowned Finger Wharf at Woolloomooloo. This apartment features a wonderful deck which is great for weekend lunches and evening drinks by the water. Boasting expansive 180 degree water views of Garden Island and Potts Point, could there be a better start and end to the day.

- Generous sized living area and outdoor terrace
- Wooden floors throughout
- CaesarStone gas kitchen with stainless steel appliances
- Built-in wardrobes and ensuite
- Internal laundry
- Reverse cycle air conditioning

**morton.com.au**

# 130/6 Cowper Wharf Road, WOOLLOOMOOLOO

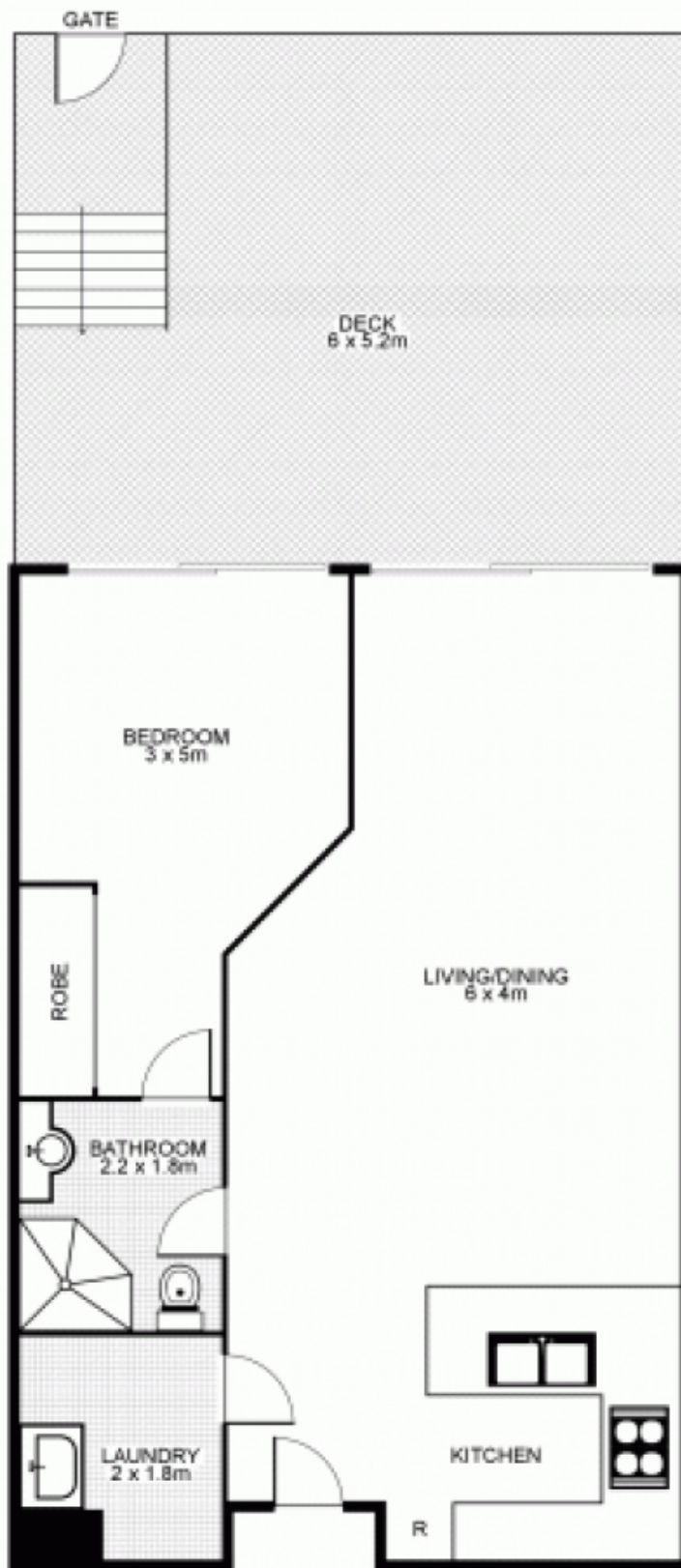

Plans by  
**surroundpix**  
com.au  
1300 30 32 40

This floor plan is intended as a guide only. Layout dimensions are approximate only. No representation or warranties of any nature whatsoever are given or intended. Any person using this information should rely on their own enquiries.