



morton.

Camperdown 4/6-8 Northwood Street

 1  1  1

On the border of Newtown/Camperdown, this converted warehouse is in one of the area's best positions. With a 70sqm design + 15sqm parking, expect plenty of space, modern finishes and immaculate presentation throughout.

- Open-plan living/dining flowing onto private outdoor area
- Stone kitchen with Smeg appliances and gas cook top
- Large bedroom with floor to ceiling built in wardrobes
- Sleek, tiled bathroom with separate shower and bath tub
- Internal laundry, gas heating bayonet and ceiling fans
- Wide sliding doors to the covered terrace
- Updated building, secure intercom entry
- Secure basement parking for one car & storage
- This apartment comes furnished as seen

View

As advertised or by appointment

Agent

Nicole Beckett

 0409 896 152

 nicole@morton.com.au

morton.com.au

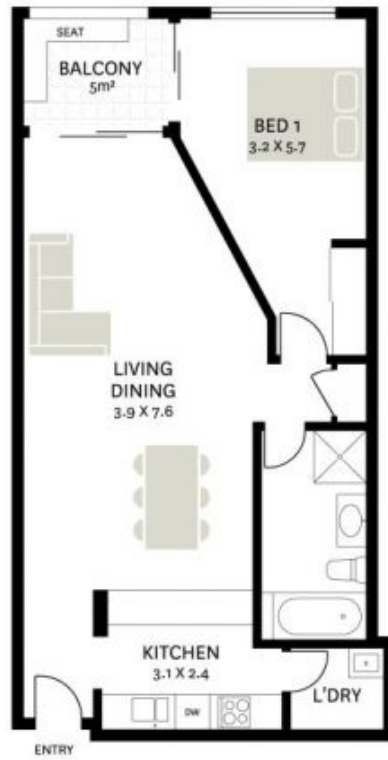

WE BELIEVE THE INFORMATION IN THIS DOCUMENT TO BE RELIABLE, HOWEVER INTERESTED PERSONS SHOULD MAKE THEIR OWN ENQUIRIES. DIMENSIONS ARE APPROXIMATE.