



morton.

Zetland 549/2C Defries Avenue

1 1 1

Located in the hub of Victoria Park, East Village offers resort-style apartment living with the largest private Sky Park in Sydney and instant access to East Village Shopping Centre below and just 3kms to the CBD.

- Reverse cycle air conditioning
- Stainless steel Smeg appliances
- Stone bench tops, mirror splash back
- One bedroom and one study
- Wool carpets, efficient LED down lights
- Gas bayonet to balcony for your BBQ
- Security building, video intercom
- One secured car space, No storage

View

As advertised or by appointment

Agent

Kristian Karaspyros

0436 477 102

kristian.karaspyros@morton.com.au

morton.com.au

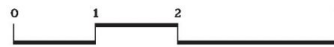

Disclaimer: This floor plan has been prepared for marketing purposes only. All descriptions, dimensions, depictions and other details in this floor plan may not be to scale and may vary to the property as built. No third party has any authority to make or give any representation or warranty in relation to the property. Your attention is drawn to the special conditions of the contract for sale. Issued 18.04.12



549 1 bed + study
1 bath
1 parking

Internal	53sqm
External	8sqm
Total	61sqm

LocationKey

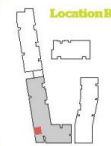

Proudly developed by



eastvillage.com.au

1800 888 688