



# morton.

**Wentworth Point** 807/14 Baywater Drive

 2  2  2

Capturing beautiful light all day, this open plan 'Messina' apartment promises a premier waterside lifestyle with spacious proportions, views, and a calming atmosphere. It has all the essentials of easy care apartment living with security, a flowing single level layout and a prime location that offers so much in terms of convenience.

- Freshly painted
- Ceiling fans in both bedrooms
- Brand new blinds and stylish sheer curtain
- Bright, breezy open layout floor plan
- Wide entertainment balcony and leafy garden outlook
- Great-sized kitchen with stone benches and gas fittings
- Lagoon style swimming pool views from bedrooms
- Oversized bedrooms and lots of built-in storage
- Two secure car spaces (side by side)
- Storage cages

### View

As advertised or by appointment

### Agent

**Nevena Petrovic**

 0428 835 910

 nevena@morton.com.au

[morton.com.au](http://morton.com.au)

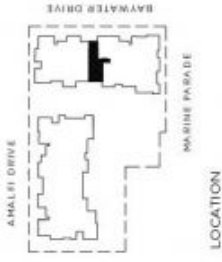

**UNIT 807  
2 BEDROOM**

INTERNAL 86 sqm  
BALCONY 16 sqm  
TOTAL AREA 102 sqm

**KEY:**

- 1 Entry
- 2 Living
- 3 Dining
- 4 Kitchen
- 5 Bedroom 1
- 6 Bedroom 2
- 7 Wardrobe
- 8 Bathroom
- 9 Ensuite
- 10 Laundry
- 11 Store
- 12 Balcony



28.10.2010  
REV. D



**THE WATERFRONT  
WENTWORTH POINT**

Disclaimer: The particulars are issued as a general outline for the purposes of providing an overview and do not constitute an offer or contract. All specifications, dimensions, materials, finishes and necessary permits, plans, drawings and other details are given as good faith and are believed to be correct. All structural drawings, specifications and other documents of the Project are available for inspection at the project office. All areas shown are approximate. The Project is subject to change without notice. The Project is subject to the terms and conditions of the relevant contract documents. The Project is subject to the relevant laws and regulations. The Project is subject to the relevant laws and regulations. The Project is subject to the relevant laws and regulations.



**MESSINA  
THE WATERFRONT**