



# morton.

**Ryde** 602/5 Meikle Place

 3  2  2

## View

As advertised or by appointment

## Agent

**Morton**



 info@morton.com.au

Set in the peaceful Canopy West development in the revered Putney Hill Estate, this executive three bedroom penthouse level apartment boasts 230sqm. of spacious living and a true north aspect. Its smart design exudes sleek urban style, with premium quality finishes, floor to ceiling windows and generous alfresco entertaining. Ideally located just minutes to Putney Public School, Putney Village, and Top Ryde City Shopping Centre.

- North facing alfresco terrace spanning 86sqm
- Stainless steel appliances and stone benchtops
- Generous built-in wardrobes throughout
- Reversed cycle ducted air-conditioning
- Secure access building with security intercom system
- Two secure basement car spaces and storage cages

[morton.com.au](http://morton.com.au)



**TYPE:** 3 BEDROOM + 2 BATHROOM

Internal Area:	117 m <sup>2</sup>
Balcony:	96 m <sup>2</sup>
Balcony Storage (S):	2 m <sup>2</sup>
Planter box:	24 m <sup>2</sup>

**TOTAL:** 229 M<sup>2</sup>

- |                  |                   |
|------------------|-------------------|
| 1. Entry         | 6. Balcony        |
| 2. Kitchen       | 7. Bedroom        |
| 3. Bathroom      | 8. Master Bedroom |
| 4. Bedroom       | 9. Ensuite        |
| 5. Living/Dining | 10. Laundry       |

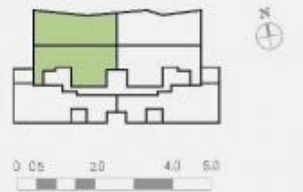

Notes: Fraser's floor plan is a preliminary illustration. The information herein is believed to be correct but is not guaranteed. Changes may be made during construction and dimensions, areas, fittings and specifications are subject to change without notice. Fraser's is not responsible for any errors or omissions. The furniture and fittings depicted are for illustrative purposes only and are not included in the contract of sale. The position of furniture and fittings may not be shown to scale. All the parties of the contract shall be bound by the contract. Prospective purchasers must rely on their own enquiries. All figures including the layout, dimensions and the area of the property, shall only be for guidance and should not be relied upon. All areas are subject to change without notice. (R/S: 1/2021)