



morton.

Wentworth Point 706/19 Hill Road

 2  2  1

Here is your opportunity to reside in this tranquil apartment, located in Sorrento, boasting an oversized floorplan ideal for entertaining and relaxing, a perfect retreat from the busy lifestyle. Offering perfect proportions throughout, you'll be spoiled with a free flowing layout, ample storage, and spacious bedrooms.

- Open plan living and dining
- Main bedroom with ensuite
- Bedrooms upstairs, living downstairs
- Split system air conditioning in living area
- Balconies off both bedrooms
- Balcony off the living area
- Quality appliances
- Gas cooking
- Single car space

View

As advertised or by appointment

Agent

Nevena Petrovic

 0428 835 910

 nevena@morton.com.au

morton.com.au



7th Floor



8th Floor

The interior style and design of this floor plan is designed for inspiration purposes to show the living spaces. It is not an exact replica of the furniture and fittings in the home.

Produced by **DIAKRIT**

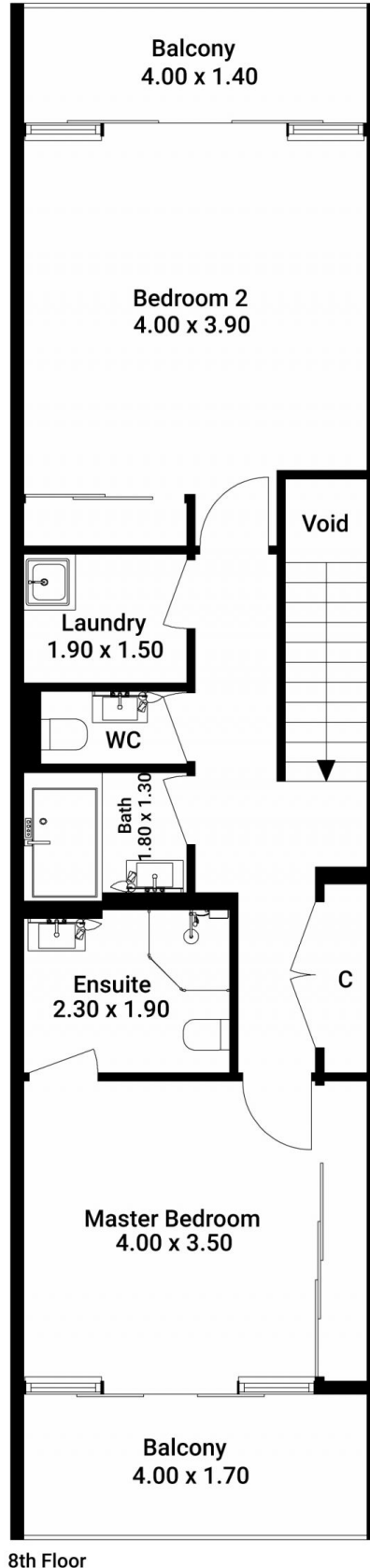
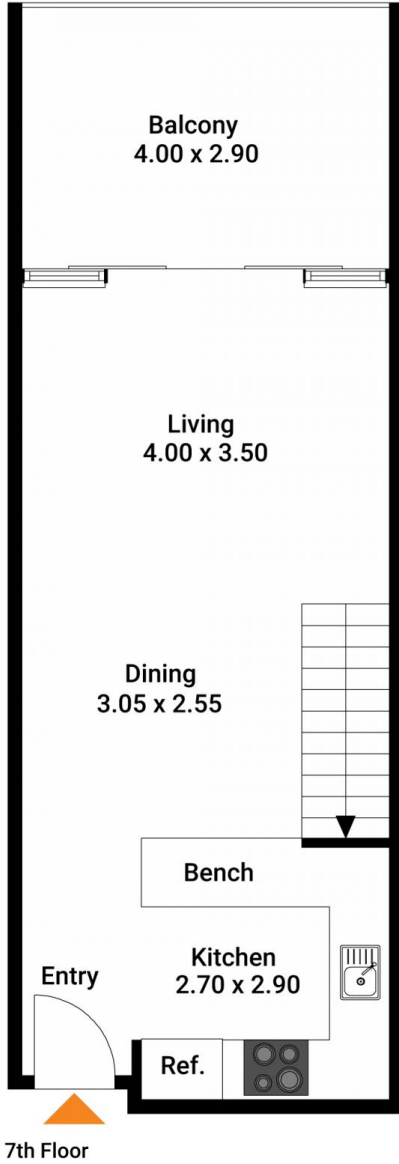

Total SQM On Title : 90 SQM

The floor plan is not to scale. Measurements are indicative and in metres.

Produced by DIAKRIT