



# morton.

Wentworth Point E9095/5 Bennelong Parkway

🛏 2 🚿 1 🚗 1

This is your opportunity to lease one of the finest apartments in Building Evian at One The Waterfront, an iconic development in Wentworth Point. One The Waterfront offers a unique luxury lifestyle with high end indoor and outdoor facilities to entertain you all year round. Located at the foot of Wentworth Point, it is in easy access to transport services to Rhodes, Parramatta and Circular Quay, with The Piazza and The Promenade just footsteps away.

- West-facing winter garden
- Generous open plan design with latest in décor finishes
- Designer kitchen with Bosch built-in appliances
- Bathroom with floor to ceiling tiles and mirrored vanity cabinet
- Spacious bedrooms with built-in wardrobes
- Internal laundry with dryer
- Split system air-conditioning
- Secure basement parking plus storage cage
- State of the art audio-visual intercom
- Exclusive roof top garden with BBQ areas

### View

As advertised or by appointment

### Agent

**Nevena Petrovic**

📞 0428 835 910

✉ nevena@morton.com.au

[morton.com.au](http://morton.com.au)

BUILDING  
ONE E



Disclaimer: This plan is a guide only and does not constitute an offer or contract. Please note changes may be made during the development and area, fittings, fixtures and specifications are subject to change without notice in accordance with the terms of the contract of sale. All parties must rely on their own investigation to validate this information as it is not guaranteed. No liability will be accepted for any inaccuracy or omissions. (Date Issued 04/05/20)

# ONE

THE WATERFRONT

APARTMENT | LOT  
**9095** | **189**

2 Bed + 1 Bath + Study

INTERNAL 83m<sup>2</sup>  
*Incl. All Seasons Living Room*

TOTAL 83m<sup>2</sup>

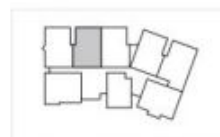

BUILDING ONE E LEVEL 9

ONE THE WATERFRONT DISPLAY CENTRE  
Shop 4E, The Piazza, 21 Bennelong Parkway  
Wentworth Point NSW 2327  
1300 865 465 [onethewaterfront.com.au](http://onethewaterfront.com.au)

DEVELOPED BY: **PIETY THP** SALES BY: **LINK**