



# morton.

**Clarendon Meadows** 16 Werona Avenue

3 1 1

This spacious family home on 530sqm level block at the end of a boutique cul-de-sac offers the perfect family home.

- Garden maintenance included
- A private and spacious backyard
- Brand new hybrid flooring installed throughout
- The layout includes separate living, dining and meals areas
- Three bedrooms all with built-in wardrobes
- Gas kitchen, linen cupboard, internal laundry, bathroom with separate toilet
- A lock-up garage with roller door access to the backyard

### View

As advertised or by appointment

### Agent

**Amy Torbarina**

0438 977 172

amy@morton.com.au

[morton.com.au](http://morton.com.au)

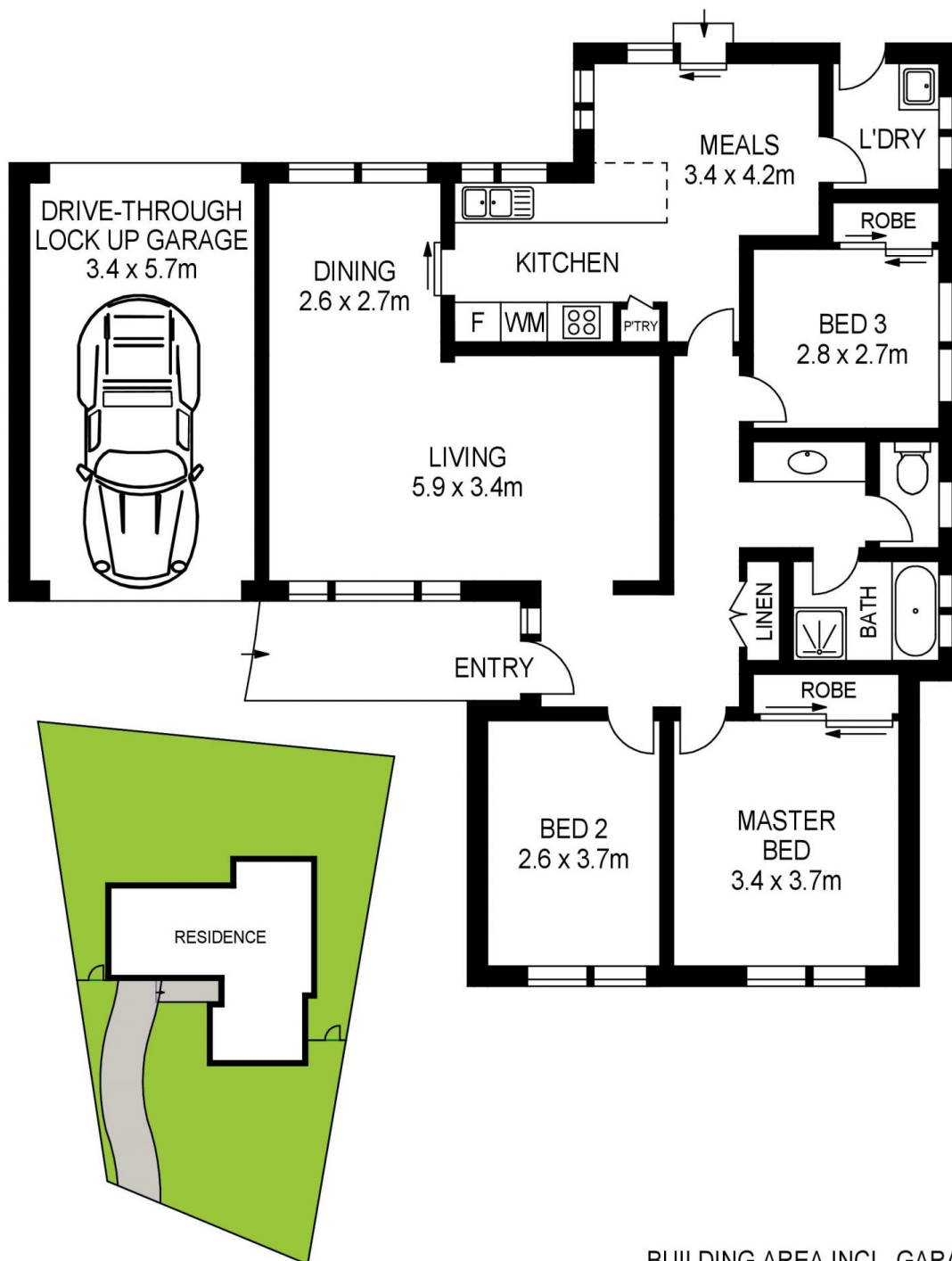

BUILDING AREA INCL. GARAGE : 140m<sup>2</sup>  
 TOTAL EXTERNAL AREA : 390m<sup>2</sup>  
 LAND AREA : 530m<sup>2</sup>

## 16 WERONA AVENUE, CLAREMONT MEADOWS



[www.assetphotographers.com.au](http://www.assetphotographers.com.au)

Please note these measurements are approximate only. The plans is intended as a rough guide for illustrative purpose. It is not warranted or guaranteed to be correct nor it is part of the sale or rental contract

