



morton.

North Sydney 245 Pacific Highway

 2  2  1

Set in a superb location convenient to both local/CBD transport. Located only a few moments away from cafes, restaurants and the CBD.

- Spacious open plan living and kitchen
- Sizeable balcony with district views
- Modern galley style kitchen, gas cooking and dishwasher
- Internal laundry with dryer
- Under cover parking and storage cage
- Secure building with intercom and lift access
- Rooftop terrace with cinema and harbour views
- Air conditioning throughout

View

As advertised or by appointment

Agent

Joseph Youll

 0410 593 248

 joseph.youll@morton.com.au

morton.com.au

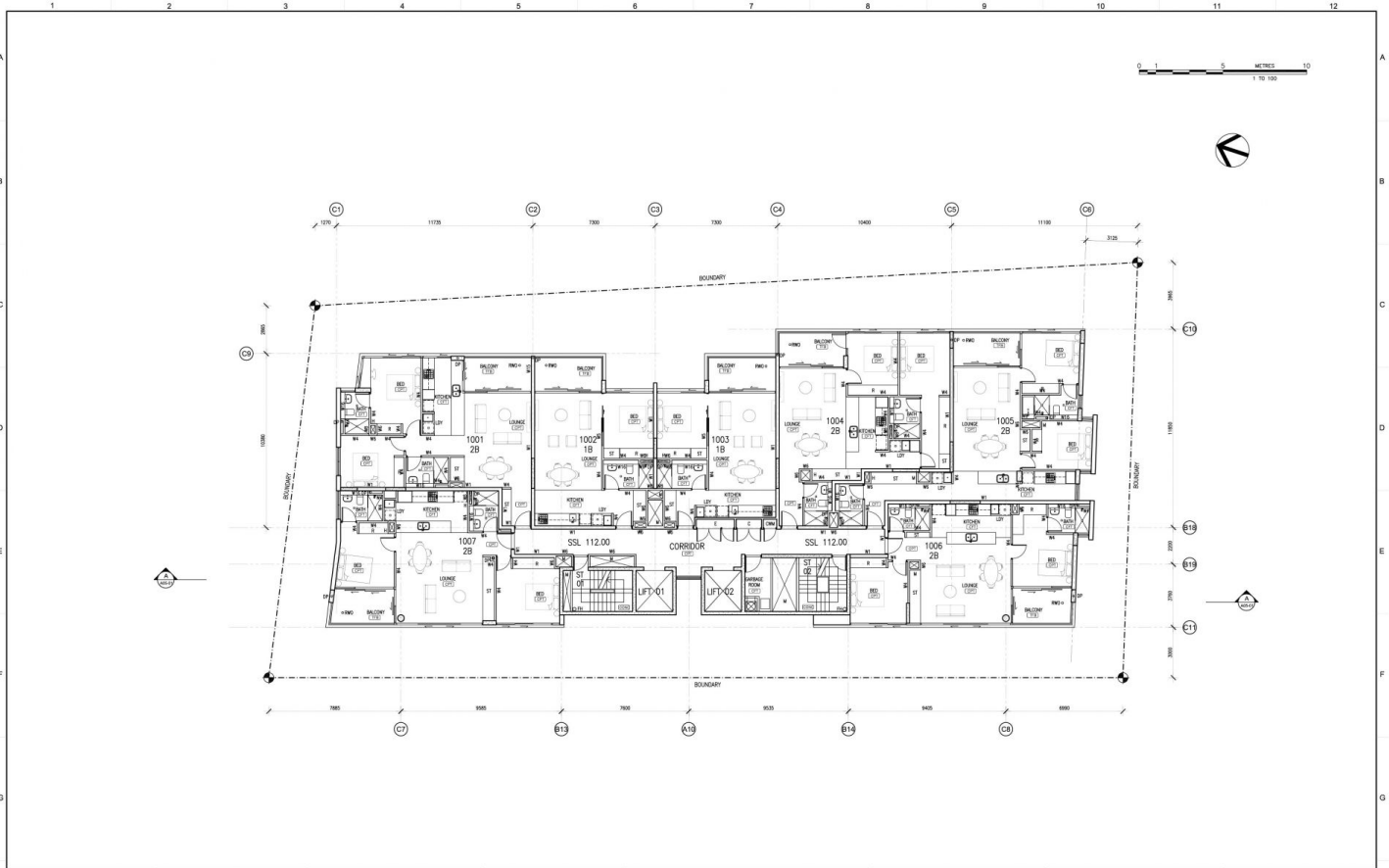

QUALITY CHECK				AMENDMENTS		NOTES		NOTES		CLIENT		DRAWING																																																			
Design Approvals	Drawn	Project	Checked	Client	Date	No.	Date	Notes	Notes	Client	Project	Project No.	DWG No.																																																		
<table border="1"> <tr> <td>DA</td> <td></td> <td></td> <td></td> <td></td> <td></td> <td></td> <td></td> <td></td> <td></td> <td>HINDMARSH CONSTRUCTION</td> <td>'MONTROSE APARTMENTS'</td> <td>12-309</td> <td>A01-14</td> </tr> <tr> <td>DC</td> <td></td> <td></td> <td></td> <td></td> <td></td> <td></td> <td></td> <td></td> <td></td> <td>LEVEL 22/25 BLIGH STREET</td> <td>238-247 PACIFIC HIGHWAY</td> <td></td> <td>B</td> </tr> <tr> <td>DD</td> <td></td> <td></td> <td></td> <td></td> <td></td> <td></td> <td></td> <td></td> <td></td> <td>SYDNEY NSW 2000</td> <td>NORTH SYDNEY</td> <td></td> <td></td> </tr> </table>	DA										HINDMARSH CONSTRUCTION	'MONTROSE APARTMENTS'	12-309	A01-14	DC										LEVEL 22/25 BLIGH STREET	238-247 PACIFIC HIGHWAY		B	DD										SYDNEY NSW 2000	NORTH SYDNEY			<table border="1"> <tr> <td>1</td> <td>2</td> <td>3</td> <td>4</td> <td>5</td> <td>6</td> <td>7</td> <td>8</td> <td>9</td> <td>10</td> <td>11</td> <td>12</td> <td></td> <td></td> </tr> </table>	1	2	3	4	5	6	7	8	9	10	11	12			<p>Copyright Caldis Cook Group Pty. Ltd.</p>	<p>Caldis Cook Group Pty. Ltd. is the owner of the copyright in these drawings, plans, designs and specifications. They must not be used, reproduced or otherwise copied or in any way the information, data and drawings contained herein without prior written consent of that company.</p>	<p>Notarized Architect: Draughton-Coxley Registration No. 4205</p> <p>CALDIS ARCHITECTS LEVEL 4 45 CHAPPEL STREET CHIPPENHAW NSW 2008 TEL: 02 9519 9277 FAX: 02 9519 9277 ACN 05 302090 www.caldisarchitects.com.au Email: projects@caldisarch.com.au</p>	<p>PROJECT 'MONTROSE APARTMENTS' 238-247 PACIFIC HIGHWAY NORTH SYDNEY NSW 2060</p>	<p>DRAWING LEVEL 10 FLOOR PLAN</p>	<p>SCALE 1:100</p>
DA										HINDMARSH CONSTRUCTION	'MONTROSE APARTMENTS'	12-309	A01-14																																																		
DC										LEVEL 22/25 BLIGH STREET	238-247 PACIFIC HIGHWAY		B																																																		
DD										SYDNEY NSW 2000	NORTH SYDNEY																																																				
1	2	3	4	5	6	7	8	9	10	11	12																																																				