



morton.

Milsons Point 310/80 Alfred Street South

 2  2  1

Just across the road from Milsons Point train station and Sydney Harbour Bridge, this ultra modern two bedroom, two bathroom, one car space apartment in sought after Milson's Point.

- Prime central location opposite Milsons Point train station
- Gourmet kitchen with stone bench top, mirrored splashback & Miele appliances
- Integrated fridge included
- Marble bathrooms
- Oak timber floorboards throughout
- Ducted reverse cycle air conditioning
- Internal laundry with washing machine and dryer provided
- Large garden terrace off lounge room and bedroom
- One allocated security car space with lift access
- Storage cage next to car space
- Milsons Point train station 67m away (approx. 2 minutes walk)
- Luna Park 500m away (approx. 5 minutes walk)

View

As advertised or by appointment

Agent

Joseph Youll

 0410 593 248

 joseph.youll@morton.com.au

morton.com.au

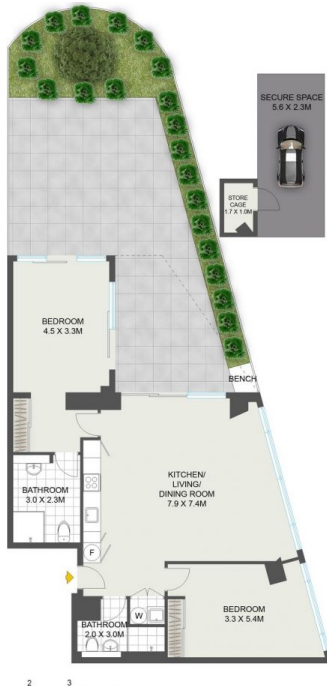

0 1 2 3 SCALE METERS

Please do not use for presentation purposes only and are not part of any legal document or file. They are subject to errors, omissions, inaccuracies and should not be used as a sole and accurate reference. Interested parties should make their own inquiries using independent sources. This floor plan is exclusively for Listing/Simmons North Sydney marketing and not shown by independent/other parties.

310/80 ALFRED STREET

MILSONS POINT