



# morton.

**Wentworth Point** 1402/2 Waterways Street



Enjoy a superb welcome to Wentworth Point living with this sleek 'Zen' apartment offering lifestyle lovers a blue-chip address with all-encompassing views over the water. Situated on the 14th level with panoramic views further up to Parramatta CBD, it blends stylish comfort with generous proportions to provide a quality living space that is perfect for today's lifestyle with its elevated aspect and easy low maintenance design.

- Recently painted and near new carpets throughout
- Designed to take full advantage of the sunlight and breath-taking views
- A light filled layout includes a spacious winter garden area
- Floor-to-ceiling walls of glass that maximise the panoramic views
- Spacious bedroom with built-in mirrored wardrobes
- Designer kitchen with great bench space and cabinetry
- Kitchen features gas cook top and oven
- Oversized security car space plus a lock-up storage cage
- Residents access to a roof garden and entertainment area

[morton.com.au](http://morton.com.au)

### View

As advertised or by appointment

### Agent

**Nevena Petrovic**

📞 0428 835 910

✉️ [nevena@morton.com.au](mailto:nevena@morton.com.au)

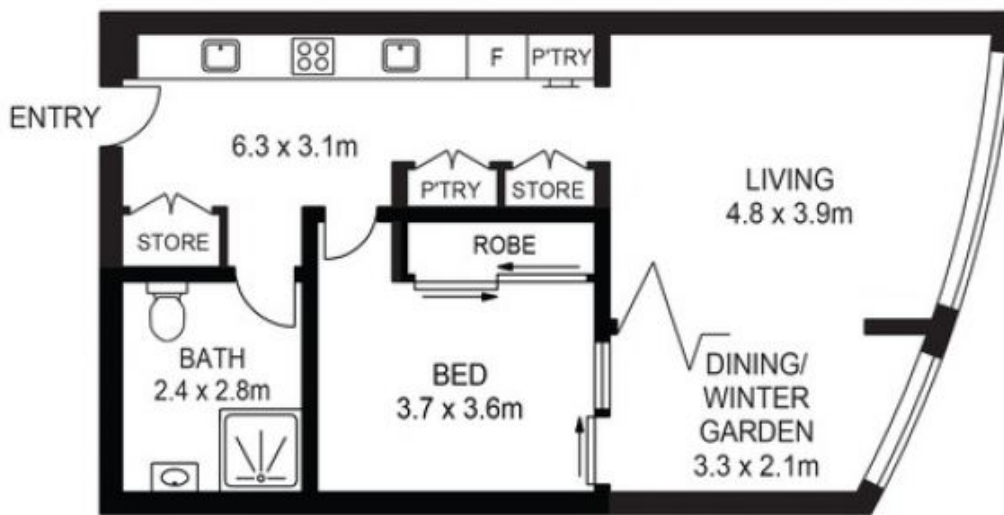
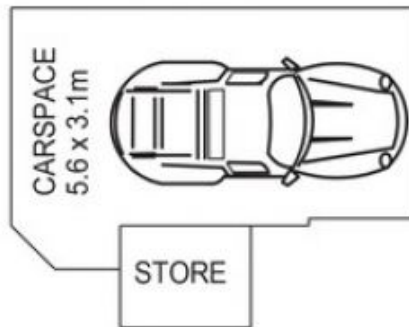

**FOURTEENTH LEVEL**

APPROX. INT. AREA : 66m<sup>2</sup>

APPROX. EXT. AREA : 16m<sup>2</sup>

**1402/ 2 WATERWAYS ST, WENTWORTH POINT**



[www.assetphotographers.com.au](http://www.assetphotographers.com.au)

Please note these measurements are approximate only. The plans are intended as a rough guide for illustrative purposes. It is not warranted or guaranteed to be correct nor is it a part of the sale or rental contract.

