



morton.

Riverwood 507/1 Vermont Crescent

 2  2  1

Experience modern, low-maintenance living in this stylish security apartment, showcasing contemporary design and generous proportions. Situated in a prime location, it offers easy access to Riverwood CBD's array of shopping, cafes, and transport options, all just a short stroll away.

- ? Generous Single-Level Layout: Spacious and well-planned for comfortable living.
- ? North-Facing Light and Airy Open Design: Abundant natural light throughout the day.
- ? Two North-Facing Double Bedrooms with Built-Ins: Ample storage and bright, inviting spaces.
- ? Two Good-Sized North-Facing Balconies: Overlooking the serene lake and park.
- ? Separate Study Room: Versatile space, ideal for a home office or guest room.
- ? Designer Kitchen: Equipped with premium European appliances for the discerning cook.
- ? Security Basement Car Space and Storage Cage: Added convenience and security.

morton.com.au

View

As advertised or by appointment

Agent

Ray Li

 0401 311 667

 ray.li@morton.com.au

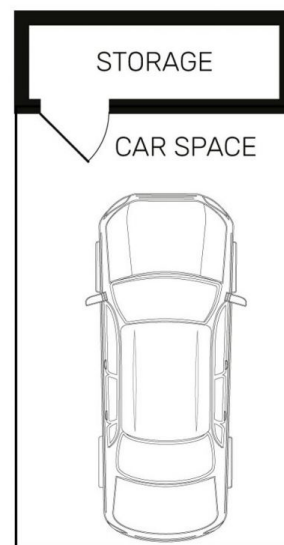
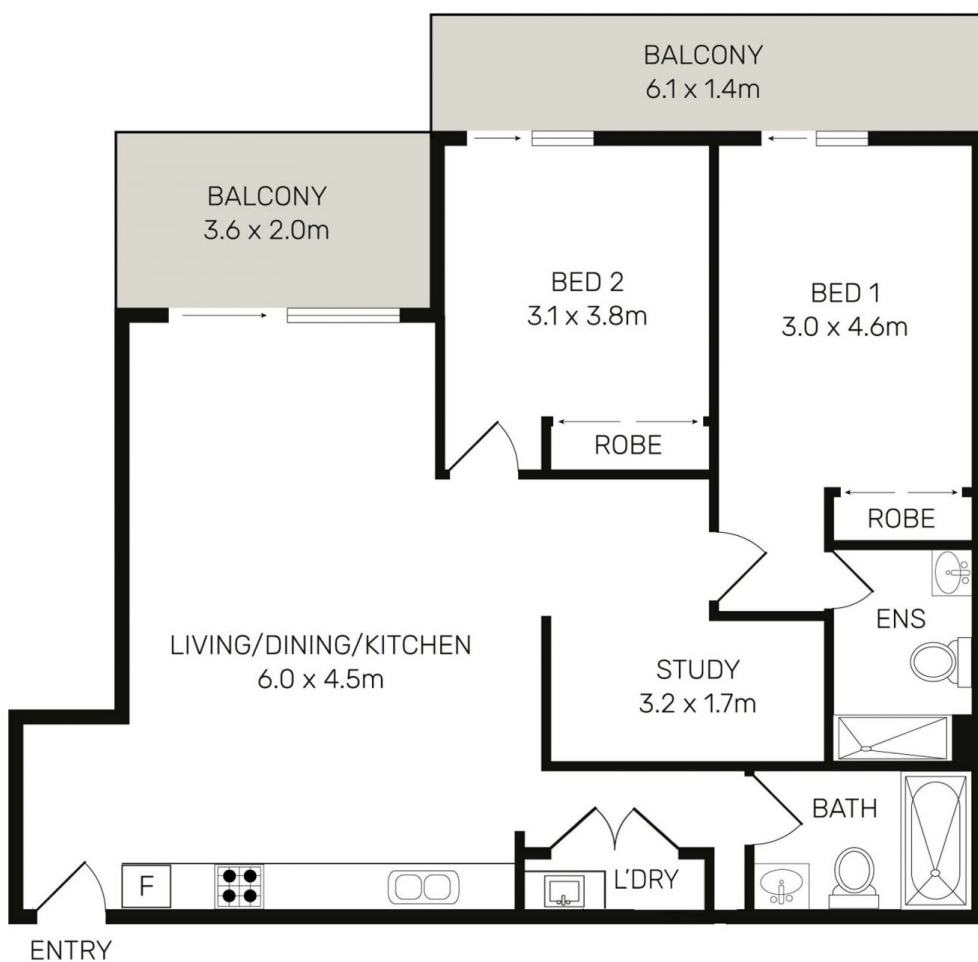

All information contained herein is gathered from all sources we believe to be reliable. However we cannot guarantee its accuracy and interested parties should rely on their own enquiries.



507/1 Vermont Crescent, Riverwood