



morton.

Wentworth Point 413/18 Corniche Drive

 2  2  2

Situated in Catania at The Waterfront, here is your opportunity to move into this spacious two bedroom apartment occupying a corner position with an L-shaped north-west facing entertainer's balcony. Only short stroll's distance from The Promenade and The Piazza's local restaurants, convenience and pharmacy stores, its central location offers prime access to public transport links off Hill Road and ferry service to Parramatta and Sydney CBD, while Wentworth Point's public school, Marina Square and Pierside retail complexes are just moments away.

- Sunny corner apartment with huge entertainers balcony
- Open plan combined living and dining
- Double galley kitchen with designer stainless steel appliances and gas cooking
- Generous size bedrooms with built-in wardrobes
- Main bathroom with bathtub, master bedroom with en-suite
- Study nook ideal for home office
- Internal laundry with clothes dryer
- Reverse cycle air conditioning

morton.com.au

View

As advertised or by appointment

Agent

Nevena Petrovic

 0428 835 910

 nevena@morton.com.au

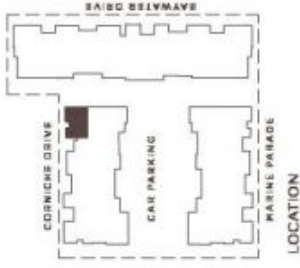

LOCATION

UNIT 413 2 BEDROOM

INTERNAL 91 sqm
BALCONY 28 sqm
TOTAL AREA 119 sqm

KEY:

- 1 Entry
- 2 Living
- 3 Dining
- 4 Kitchen
- 5 Bedroom 1
- 6 Bedroom 2
- 7 Wardrobe
- 8 Study
- 9 Bathroom
- 10 Ensuite
- 11 Laundry
- 12 Store
- 13 Balcony



REV. D



Disclaimer: The purchaser should use this plan as a guide only for the purposes of identifying parameters and do not constitute an offer or contract. All descriptions, dimensions, references to architects and necessary parameters for use and other details are given in good faith and are believed to be correct, but any intending purchaser should verify all details in documents or representations of fact, for and solely their own benefit, and where necessary seek advice. No third party responsible for their actions, but any authority to make or give any representation or warranty in relation to this property.
* External areas may be subject to development opportunities, refer to the site plan and site plan.