



morton.

St Marys 66 Sydney Street

 3  1  12

This spacious family home is located close to St Marys CBD, Oxley Park public school and main arterial roads.

Please note property has been renovated since the photos were taken

- Massive 18m x 7.5m workshop ideal for the car/truck enthusiast
- Plenty of side access to backyard
- Three bedrooms plus study
- Formal lounge and dining
- Large rumpus/games room

View

As advertised or by appointment

Agent

Anthony Fleming

 0437 929 484

 anthonyf@morton.com.au

morton.com.au

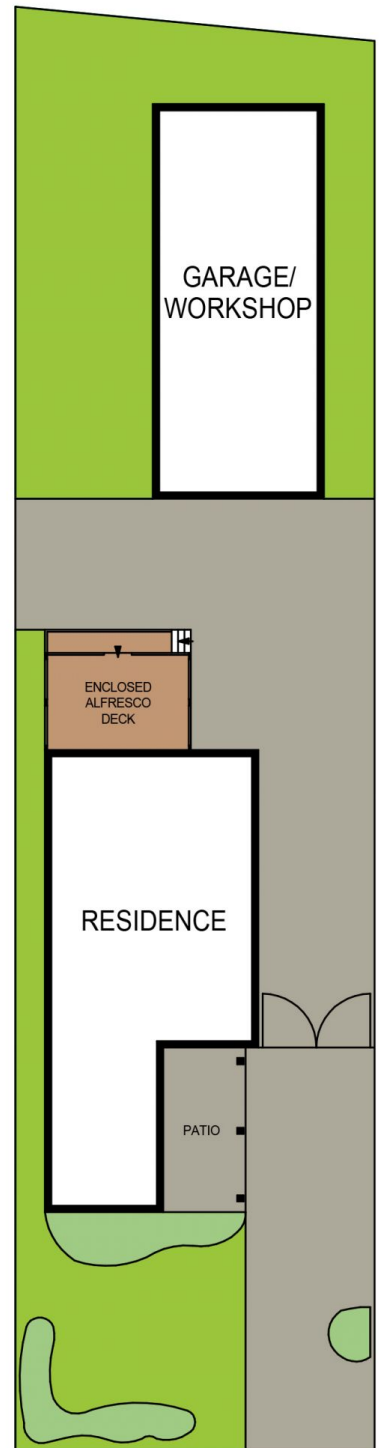
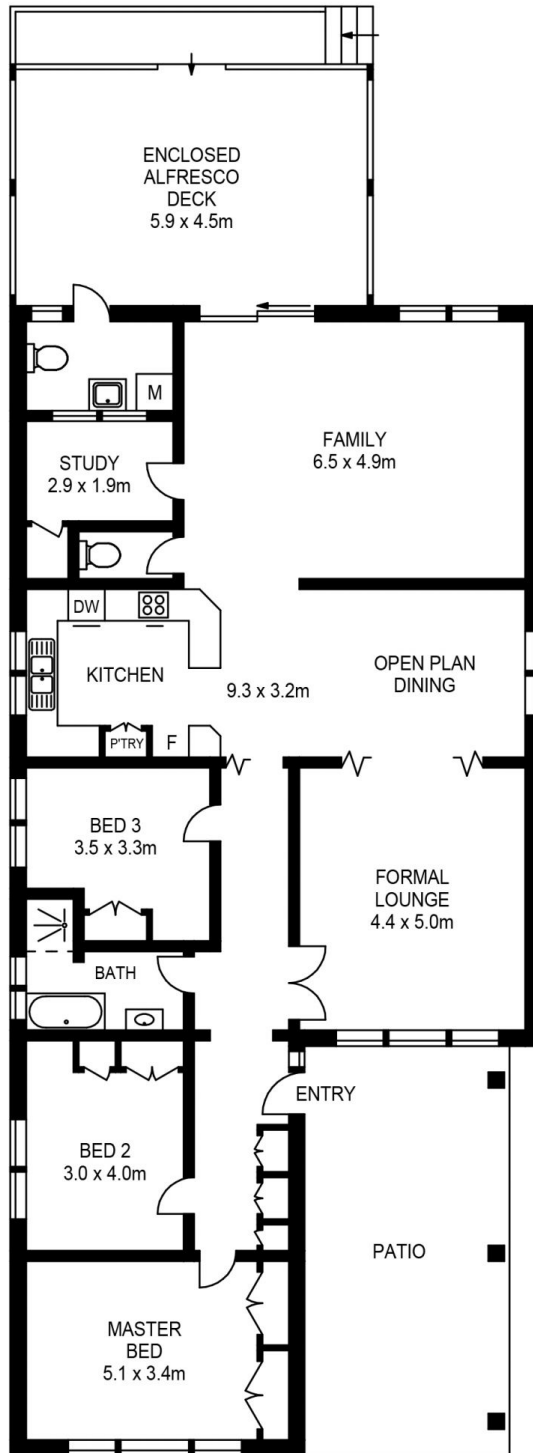
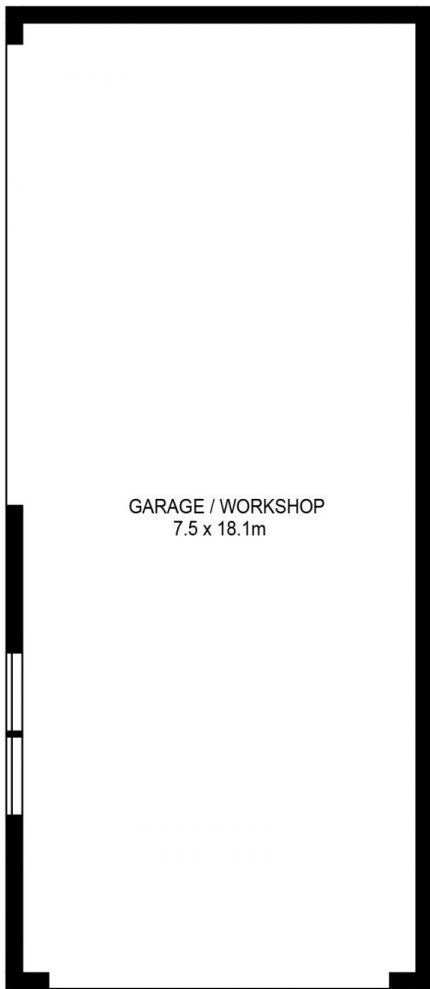

APPROX. INT. AREA : 303 m²
APPROX. EXT. AREA : 67 m²
TOTAL AREA INCLUDING CAR SPACE AND STORAGE : 370 m²

66 SYDNEY STREET, ST MARYS



www.assetphotographers.com.au

Please note these measurements are approximate only. The plans is intended as a rough guide for illustrative purpose. It is not warranted or guaranteed to be correct nor is it part of the sale or rental contract

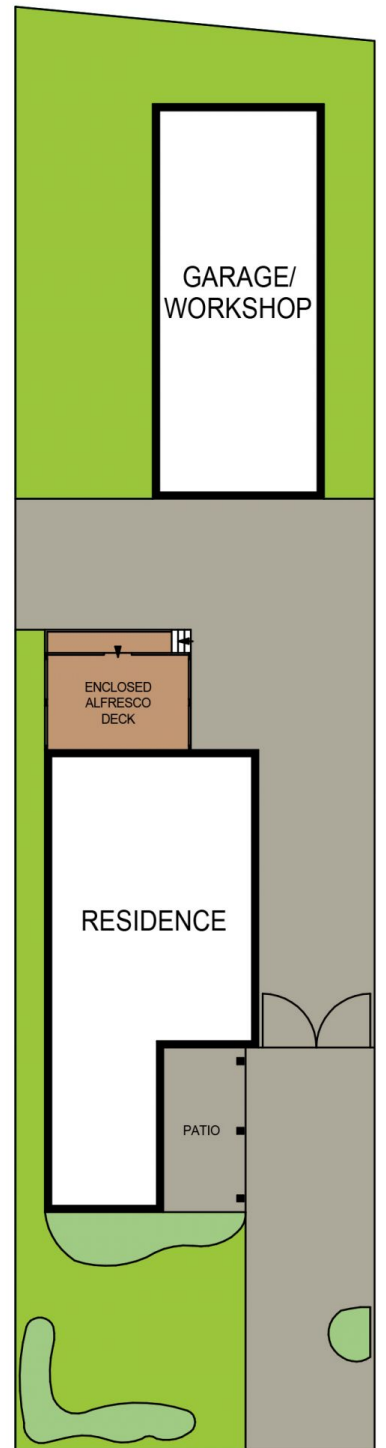
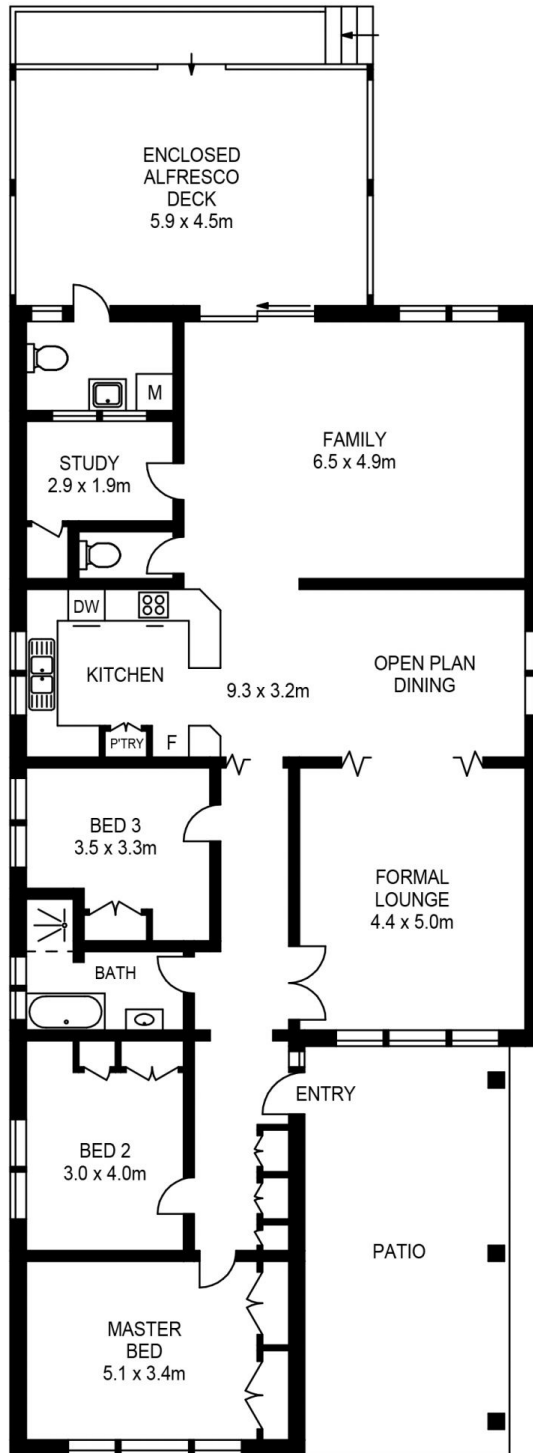
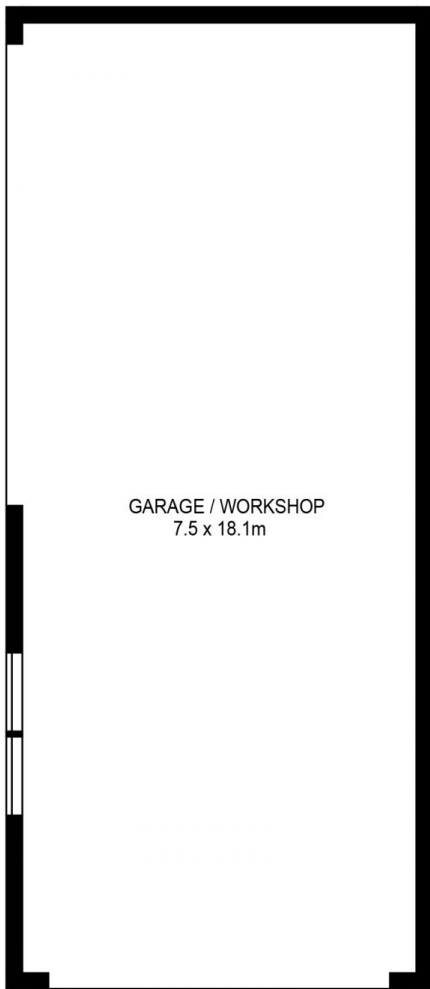

APPROX. INT. AREA : 303 m²
APPROX. EXT. AREA : 67 m²
TOTAL AREA INCLUDING CAR SPACE AND STORAGE : 370 m²

66 SYDNEY STREET, ST MARYS



www.assetphotographers.com.au

Please note these measurements are approximate only. The plans is intended as a rough guide for illustrative purpose. It is not warranted or guaranteed to be correct nor is it part of the sale or rental contract