



morton.

St Leonards 503/567 Pacific Highway

 1  1  1

Showcasing all the essentials of the ultimate apartment lifestyle, this as-new designer residence is set in the Northern Lights boutique complex and is immediately impressive. It combines light filled interiors, sleek contemporary finishes. From this premier location it is two minutes walk to the future Metro Station, an easy stroll to St Leonards station and Crows Nest cafes with buses, trains and parks all moments from the doorstep.

- Superb investment property offering strong rental potential
- Fresh and bright interiors feature an open plan design
- Modern style kitchen with breakfast bench, gas cooking and dishwasher
- Generous separate bedroom area with extensive built-in robes
- Seamless flow to sunny and spacious balcony
- Ducted air conditioning, video intercom and lift access
- Pet-friendly development; storage cage on title
- Ideally located less than 4kms to Sydney's CBD
- Walk to rail, Express City bus, North Sydney CBD, parks &



morton.com.au

View



As advertised or by appointment

Agents

Konstantin Melnikov

 0421 540 424
 konstantin@morton.com.au

Ferenc Goemoeri

 0447 025 423
 ferenc@morton.com.au

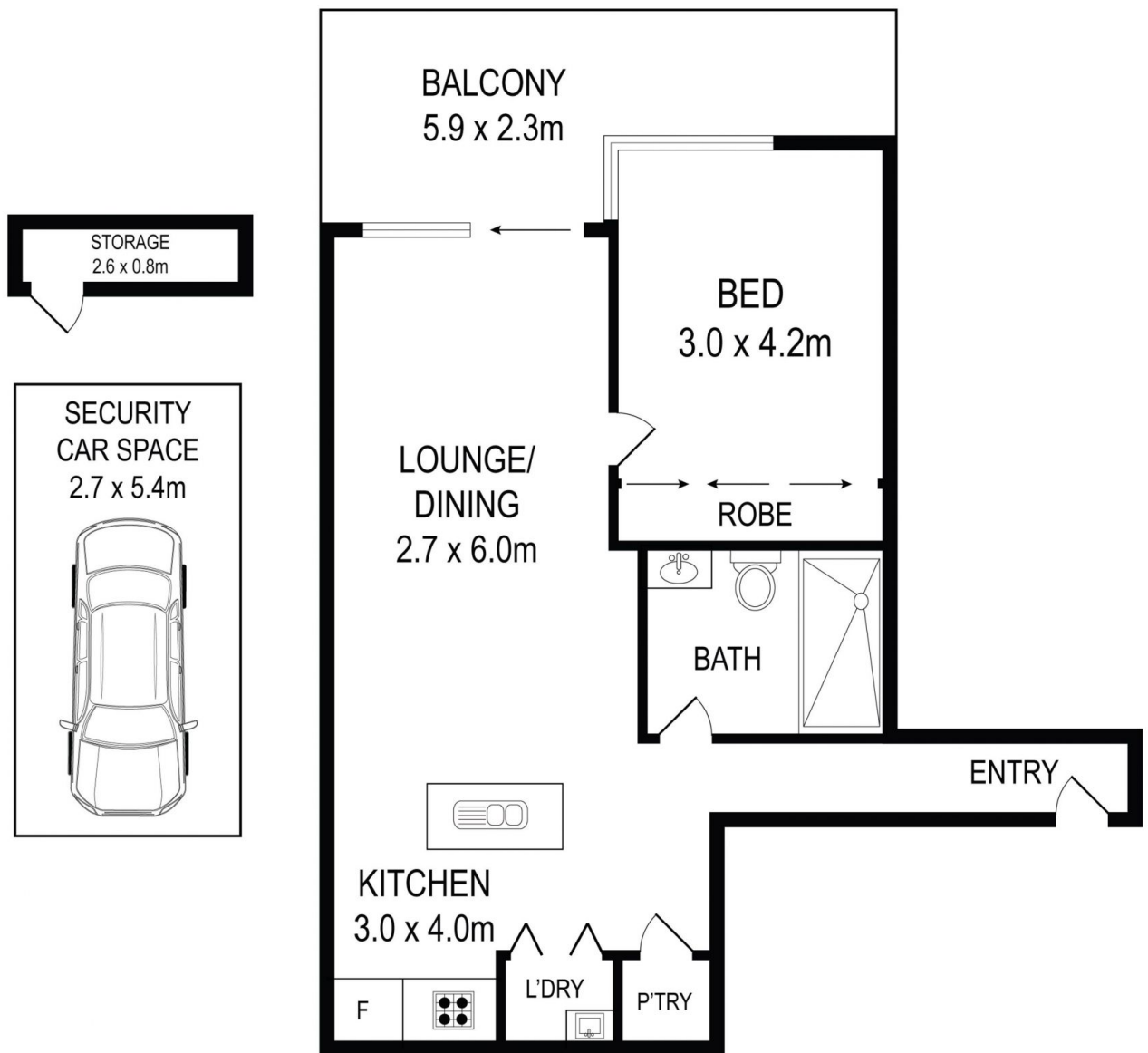

All information contained herein is gathered from all sources we believe to be reliable. However we cannot guarantee its accuracy and interested parties should rely on their own enquiries.



503/567-573 Pacific Highway, St Leonards