



morton.

Petersham 13 Brighton Street

 3
  3
  2

This gorgeous property is located in a renowned leafy street lined with period residences. This impressive home has been tastefully renovated and well thought out to maximize style and elegance. Located just down the road from the Petersham train station, across the road from Petersham Early Childhood Education Centre & within minutes from the Petersham park, schools, popular cafes & Fanny Durack Aquatic Centre. The versatile garage is perfect for working from home and could easily be utilized as a guest house, home office, home gym or a teenage retreat.

- Character home with an oversized double lock up garage
- Tastefully renovated with high end finishes throughout
- Great size backyard/courtyard perfect for entertaining
- Split system A/C fitted in the living room, lounge room, all bedrooms & in the garage
- Enormous garage/multiuse space with mezzanine storage above, perfect for extra storage
- Three full size bathrooms
- Large functional laundry

morton.com.au

View

As advertised or by appointment

Agent

Nevena Petrovic

 0428 835 910

 nevena@morton.com.au

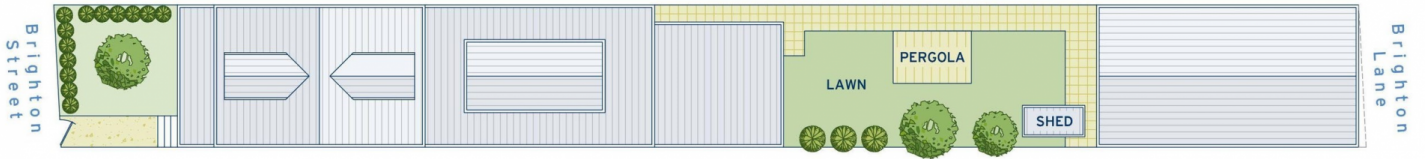

SITE PLAN

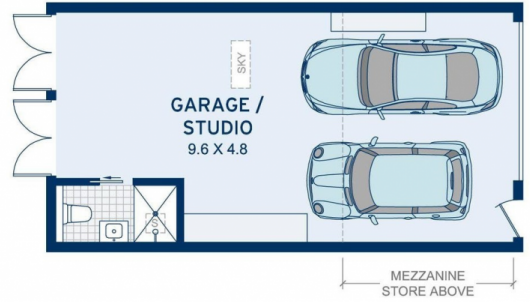

LEVEL ONE

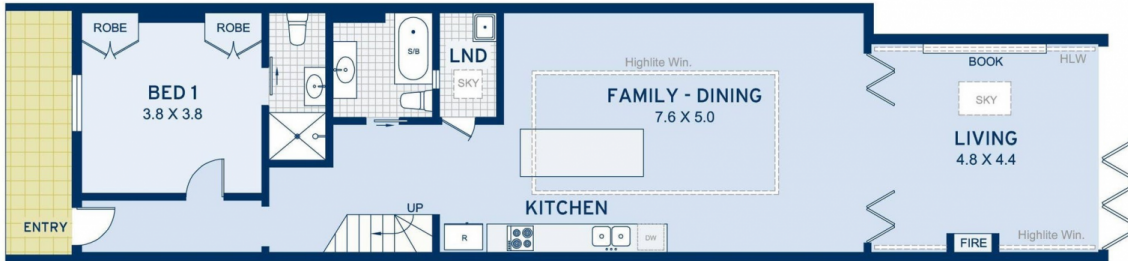

APPROXIMATE AREAS	
Internal Floorspace	145sqm
Garage	46sqm
External	101sqm
Land Size	272sqm