



# morton.

**North Sydney** 245 Pacific Highway

 2  2  1

Set in a superb location convenient to both local/CBD transport. Located only a few moments away from cafes, restaurants and the CBD.

- Spacious open plan living and kitchen
- Sizeable balcony with district views
- Modern galley style kitchen, gas cooking and dishwasher
- Internal laundry with dryer
- Under cover parking and storage cage
- Secure building with intercom and lift access
- Rooftop terrace with cinema and harbour views
- Air conditioning throughout

### View

As advertised or by appointment

### Agent

**Joseph Youll**

 0410 593 248

 joseph.youll@morton.com.au

[morton.com.au](http://morton.com.au)

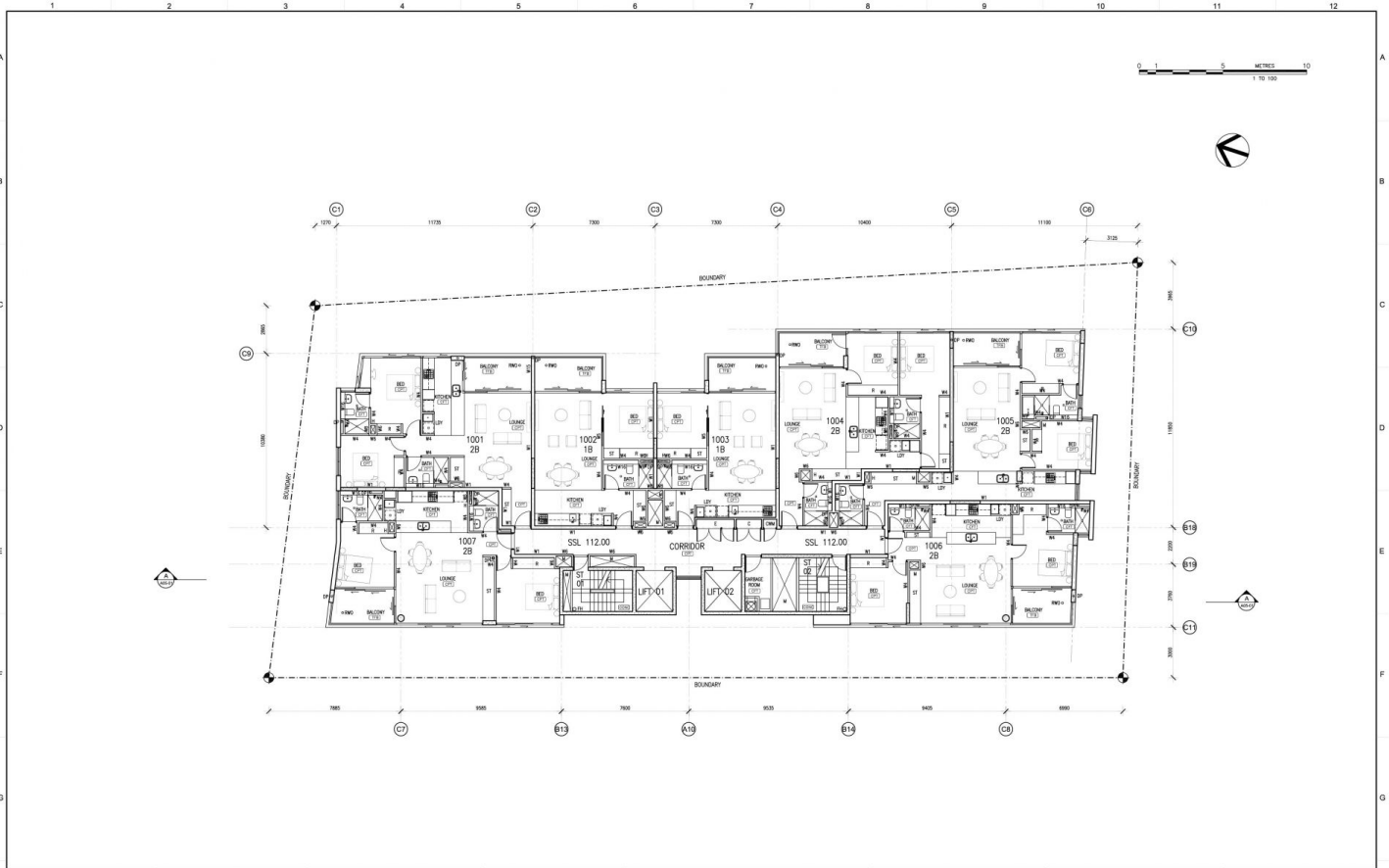

QUALITY CHECK				AMENDMENTS		NOTES		NOTES		CLIENT		DRAWING	
Drawn	Checked	Client	Date	No.	Date			Noted Architect: Draughton-Coxley Registration No. 4205 <b>CALDIS ARCHITECTS</b> LEVEL 4 45 CHATELAIN STREET CHERRYBROOK NSW 2051 TEL: 02 9519 9277 FAX: 02 9519 9277 A/CN 05 302905 www.caldis.com.au Email: projects@caldis.com.au A/CN 05 302 900		<b>CLIENT</b> HINDMARSH CONSTRUCTION LEVEL 22/25 BLIGH STREET SYDNEY NSW 2000  <b>PROJECT</b> 'MONTROSE APARTMENTS' 238-247 PACIFIC HIGHWAY NORTH SYDNEY NSW 2060		<b>DRAWING</b> LEVEL 10 FLOOR PLAN  PROJECT No. 12-309 DWG No. A01-14 SCALE 1:100	
Copyright Caldis Cook Group Pty. Ltd. Caldis Cook Group Pty. Ltd. is the owner of the copyright in the drawings, plans, designs and specifications. They must not be used, reproduced or otherwise used in any way without the written consent of Caldis Cook Group Pty. Ltd.													