



# morton.

Penrith 117/25-31 Hope Street

2 2 1

The Nepean is a boutique development of 53 luxury near new 1,2 & 3 bedroom unfurnished apartments. Located in a quiet street in the hub of Penrith in-between Penrith and Kingswood train stations, with a walking distance to the Neapan hospital and a short drive to everything Penrith has to offer, enjoying breathtaking views of the picturesque Blue Mountains.

This spacious 93 sqm near new two-bedroom is a not-to-miss, features with a Stylish modern kitchen with very generous stone benchtop spaces, large open and bright living, sizeable undercover balcony.

- Entertainer's balcony with the Blue Mountains & district views
- Gallery kitchen w four-burner gas cooktop with ample storages
- Fisher & Paykel stainless steel appliances included
- Effective LED lightings throughout living, dining and kitchen
- Split A/C, Study area, payTV points in the living room
- Premium grade carpeted bedrooms both w mirrored built-in
- Master opening onto the balcony with quality en-suite

[morton.com.au](http://morton.com.au)

### View

As advertised or by appointment

### Agent

**Amy Torbarina**

0438 977 172

amy@morton.com.au



# THE NEPEAN

PENRITH

25-31 Hope Street, Penrith, NSW, 2750



## KEY PLAN

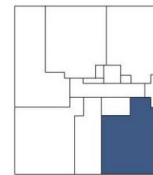

BUILDING 1

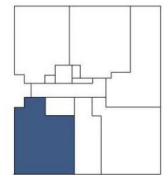

BUILDING 2

## APARTMENT TYPE 6B

2 BEDROOM

INTERNAL	81m <sup>2</sup>
BALCONY	12m <sup>2</sup>
<b>TOTAL AREA</b>	<b>93m<sup>2</sup></b>

## APARTMENT NUMBERS:

117, 127, 137, 217, 227, 237

\*NOTE: APARTMENT TYPES SHOWN INDICATE LAYOUT IN BUILDING 2. APARTMENTS LOCATED IN BUILDING 1 ARE MIRRORED COPIES OF THIS TYPE.



Provisions for storage cage in basement.



1 X Car Space



  
**BUILDEX**  
DEVELOPER

**MORSON GROUP**  
ARCHITECT

DISCLAIMER:  
Available off-the-plan documentation, advertising and marketing materials and images (marketing materials) are either computer generated and digitally produced artist impressions and or otherwise intended as a guide only. All measurements are approximate only and have been calculated using the centre line of party walls and the outside face of external and passageway walls.