



morton.

Ermington 418/24-32 Koorine Street

 2  2  2

Sirocco offers lifestyle apartment living within the masterplanned community in Ermington. Perched on the waters edge, easy access to the river, cycleway and parks.

- Absolute water view
- Extra high ceiling
- Generous study room with extra storage cupboard
- Spacious floorplan with wintergarden
- Reverse cycle air conditioning
- Quality SMEG stainless steel kitchen appliances
- Gourmet kitchen with stone bench tops & splashback
- LED under cupboard lighting
- Wool blend carpets, efficient LED down lights
- Data/TV points in living and main bedroom
- Timber look tile in living areas & kitchen
- Two car spaces + storage cage

To register your interest and be kept up to date with inspections times, please click "Request Inspection", "Send Enquiry" or book an inspection directly at

morton.com.au

View

As advertised or by appointment

Agent

Nevena Petrovic

 0428 835 910

 nevena@morton.com.au



SIROCCO II

**APARTMENT 418
LOT 104**

2 BEDROOM + STUDY

Internal (Including Winter Garden)	104 sqm
Total	104 sqm

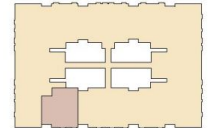

SIROCCO II - LEVEL 4

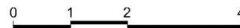

Disclaimer: This floor plan has been prepared for marketing purposes only. All descriptions, dimensions, depictions and other details in this floor plan may not be to scale and may vary from the property as built. Your attention is drawn to the special conditions of the contract for sale of land. No third party has any authority to make or give any representation or warranty in relation to the property unless the representation or warranty is confirmed by the vendors and included in the contract for sale of land. Date Issued: 05/12/14 Revision: C