



morton.

Zetland 8/1 Defries Avenue

 1  1

Designed by award winning architects Turner + Associates, this spacious one bedroom apartment is Located in the ever popular ESP building in Victoria Park. Light filled and open plan as well as a quiet easterly aspect, this apartment is set ideally across the road from the impressive East Village shopping centre.

- Brand new carpets
- Gourmet kitchen with high quality stainless steel appliances
- Excellent layout with open plan living and dining area
- Spacious bedroom with built in wardrobes
- Oversized bathroom with bath tub
- Separate laundry and plenty of storage
- Security access with intercom entry
- Landscaped gardens, gym and indoor swimming pool
- Numerous bus services to the CBD, airport, UNSW and beaches

View

As advertised or by appointment

Agent

Kristian Karaspyros

 0436 477 102

 kristian.karaspyros@morton.com.au

morton.com.au

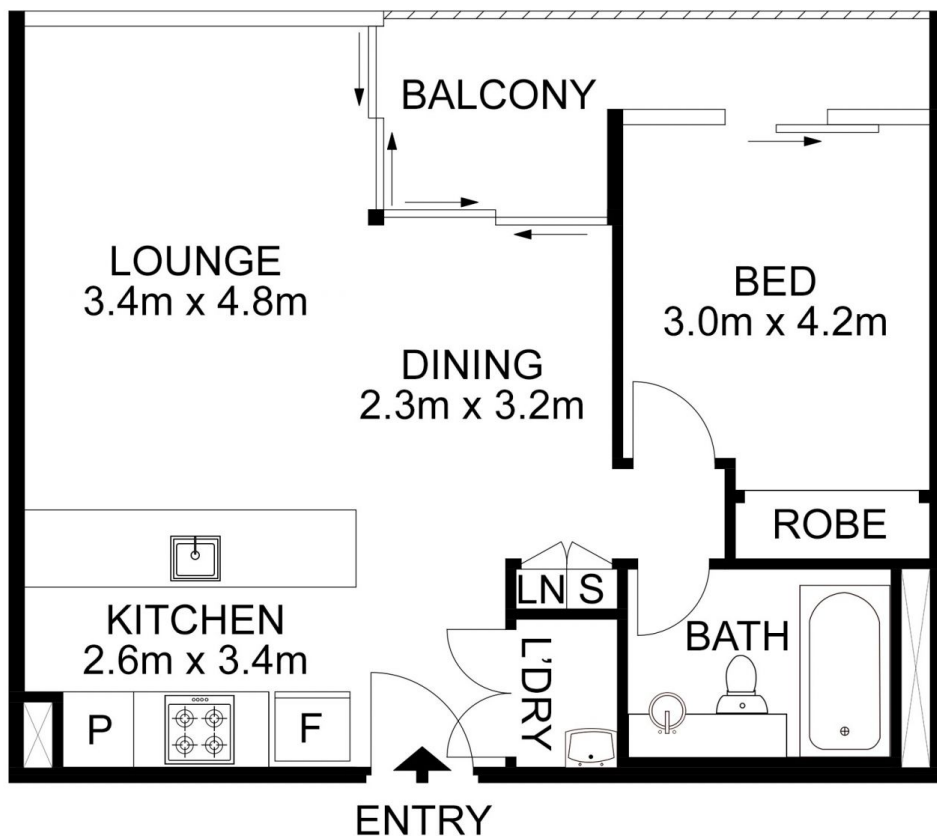

All information contained herein is gathered from all sources we believe to be reliable. However we cannot guarantee its accuracy and interested parties should rely on their own enquiries.



morton.

Zetland 8/1 Defries Avenue