

morton.

Wentworth Point 632/26 Baywater Drive

 2  2  2

With respect to the latest government's COVID-19 restrictions we will be conducting open homes and private appointments with mandatory face masks, sanitisation, QR code check ins, and 1 person per 4sqm. Please submit an enquiry or contact the agent to be kept up to date with inspection times and register your attendance for viewings.

Situated in Catania within The Waterfront estate, this modern low maintenance two bedroom apartment is the perfect residence for lifestyle and convenience. With secure basement parking and located directly across from public transport links, you'll be footsteps away from Wentworth Point's exclusive Pulse Club. You'll find The Piazza, Marina Square, and Pierside retail quarters reachable within moments, and surrounding parklands and recreational facilities at your fingertips. This neat abode is sure to meet your lifestyle needs.

- Located on level six with spectacular water views
- Combined living and dining room

morton.com.au

View

As advertised or by appointment

Agent

Nevena Petrovic

 0428 835 910

 nevena@morton.com.au

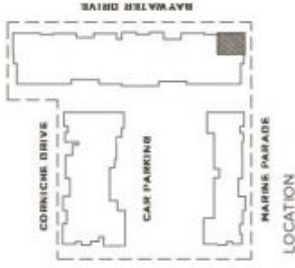

LOCATION

UNIT 632 2 BEDROOM

INTERNAL 90 sqm
BALCONY 22 sqm
TOTAL AREA 112 sqm

KEY:

- 1 Entry
- 2 Living
- 3 Dining
- 4 Kitchen
- 5 Bedroom 1
- 6 Bedroom 2
- 7 Wardrobe
- 8 Study
- 9 Bathroom
- 10 Ensuite
- 11 WC
- 12 Laundry
- 13 Store
- 14 Balcony/Courtyard

REV. A

