



morton.

Zetland 828/2 Kirby Walk

 1  1  1

With respect to the latest government's COVID-19 restrictions we will be conducting open homes and private appointments with mandatory face masks, sanitisation, QR code check ins, and 1 person per 4sqm. Please submit an enquiry or contact the agent to be kept up to date with inspection times and register your attendance for viewings.

This one bedroom plus study apartment is located in the sought-after building 'Platinum'. Located in the vibrant Victoria Park precinct, just 3km from the CBD, the Platinum development by Payce is sophisticated urban living at its best. Platinum's five buildings surround a beautifully landscaped 1,930sqm elevated garden incorporating an alfresco dining and barbecue area, intimate pavilions for relaxing and an Asian-inspired bamboo grove.

- Air conditioning throughout
- Modern gas kitchen with stainless steel Miele appliances and dishwasher
- Balcony with gas bayonet, perfect for entertaining



morton.com.au

View

As advertised or by appointment

Agents

Sarah Fowell

 0437 492 129
 sarah@morton.com.au

Kristian Karaspyros

 0436 477 102
 kristian.karaspyros@morton.com.au



*High level window
 Disclaimer: This floor plan has been prepared for marketing purposes only. All descriptions, dimensions, depictions and other details in this floor plan may not be to scale and may vary to the property as built. No third party has any authority to make or give any representation or warranty in relation to the property. Your attention is drawn to the special conditions of the contract for sale. Date Issued: 03/12/12 Revision: D

PLATINUM

BY PAYCE

APARTMENT
828
 1 BEDROOM

INTERNAL 51 SQM
 EXTERNAL 6 SQM
TOTAL 57 SQM

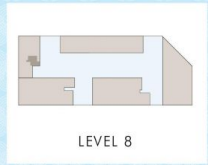

PROUDLY DEVELOPED BY:



1300 778 777
 platinumbypayce.com.au