



morton.

Wentworth Point G12111/1 Bennelong Parkway

 1  1  1

Great opportunity to lease one of the finest apartments at One The Waterfront, an iconic development in Wentworth Point. Located at the foot of Wentworth Point, it is in easy access to transport services to Rhodes, Parramatta and Circular Quay.

- Generous open plan design with latest in décor finishes
- Quality designer kitchen with Bosch built- in appliances
- Bathroom has floor to ceiling tiles, mirrored vanity cabinet
- Spacious bedroom with built-in robe
- Internal laundry with dryer, air-conditioning
- Security parking, video intercom
- Beautiful roof top garden with BBQ areas, onsite building manager
- Views to the water, parklands and the CBD skylines
- Close to restaurants, Olympic Park, ferry wharf and specialty stores

View

As advertised or by appointment

Agent

Nevena Petrovic

 0428 835 910

 nevena@morton.com.au

morton.com.au

**BUILDING
ONE G**



Disclaimer: This plan is a guide only and does not constitute an offer or contract. These notes change may be made during the development and area, fittings, fixtures and specifications are subject to change without notice in accordance with the terms of the contract of sale. All parties must rely on their own investigation to validate the information as it is not guaranteed. No liability will be accepted for any misreading or misinterpretation. (Date Issued 04/10/18)

ONE
THE WATERFRONT

APARTMENT | LOT
12111 | 259

1 Bed

INTERNAL 53m²
EXTERNAL 9m²
TOTAL 62m²

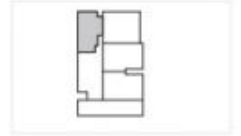

BUILDING ONE G LEVEL 12

ONE THE WATERFRONT DISPLAY CENTRE
Shop 4E, The Piazza, 21 Bennelong Parkway
Wentworth Point NSW 2127
1300 865 465 onethewaterfront.com.au

DEVELOPED BY **PIETY THP** SALES BY **LINK**