



morton.

Wentworth Point 1402/2 Waterways Street



With respect to the latest government's COVID-19 restrictions we will be conducting open homes and private appointments with mandatory face masks, sanitisation, QR code check ins, and 1 person per 4sqm. Please submit an enquiry or contact the agent to be kept up to date with inspection times and register your attendance for viewings.

Enjoy a superb welcome to Wentworth Point living with this sleek 'Zen' apartment offering lifestyle lovers a blue-chip address with all-encompassing views over the water. Situated on the 14th level with panoramic views further up to Parramatta CBD, it blends stylish comfort with generous proportions to provide a quality living space that is perfect for today's lifestyle with its elevated aspect and easy low maintenance design.

- New paint and new carpets throughout
- Designed to take full advantage of the sunlight and breath-taking views
- A light filled layout includes a spacious winter garden area

morton.com.au

View

As advertised or by appointment

Agent

Sarah Fowell

📞 0437 492 129

✉ rentals@morton.com.au

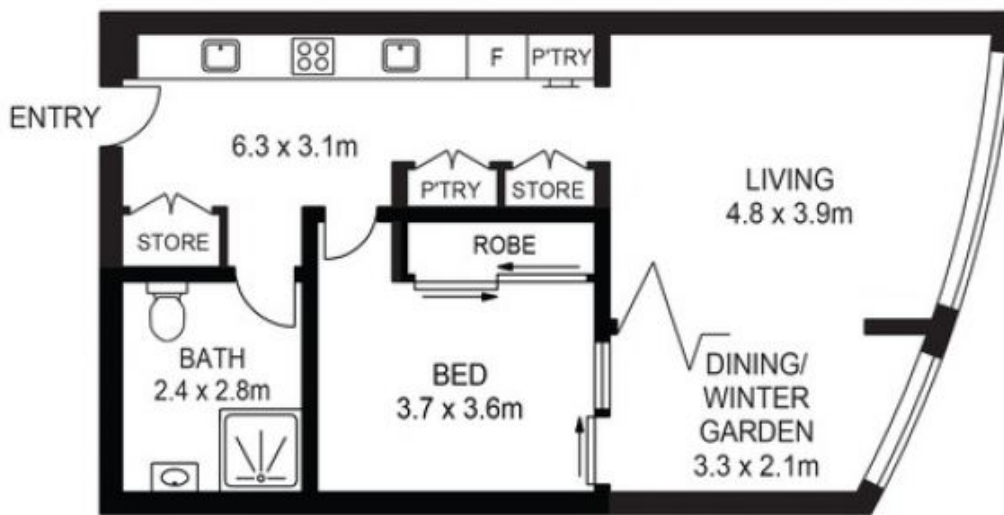
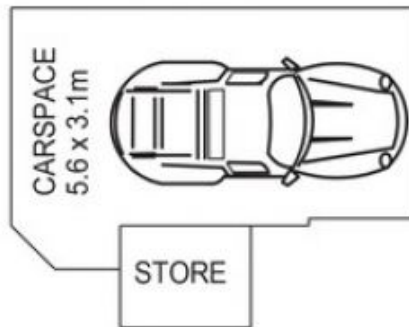

FOURTEENTH LEVEL

APPROX. INT. AREA : 66m²

APPROX. EXT. AREA : 16m²

1402/ 2 WATERWAYS ST, WENTWORTH POINT



www.assetphotographers.com.au

Please note these measurements are approximate only. The plans are intended as a rough guide for illustrative purposes. It is not warranted or guaranteed to be correct nor is it a part of the sale or rental contract.

