



morton.

Wentworth Point 1402/2 Waterways Street

1
 1
 1

Enjoy a superb welcome to Wentworth Point living with this sleek 'Zen' apartment offering lifestyle lovers a blue-chip address with all-encompassing views over the water. Situated on the 14th level with panoramic views further up to Parramatta CBD, it blends stylish comfort with generous proportions to provide a quality living space that is perfect for today's lifestyle with its elevated aspect and easy low maintenance design.

- Designed to take full advantage of the sunlight and breath-taking views
- A light filled layout includes a spacious wintergarden area
- Floor-to-ceiling walls of glass that maximise the panoramic views
- Spacious bedroom with built-in mirrored wardrobes
- Designer kitchen with good storage and gas cooktop
- Oversized security car space plus a lock-up storage cage
- Residents access to a roof garden and entertainment area
- Designer full bathroom, internal laundry, intercom and lift

View

As advertised or by appointment

Agent

Dylan Choe

0416 932 977

dylanchoe@morton.com.au

morton.com.au

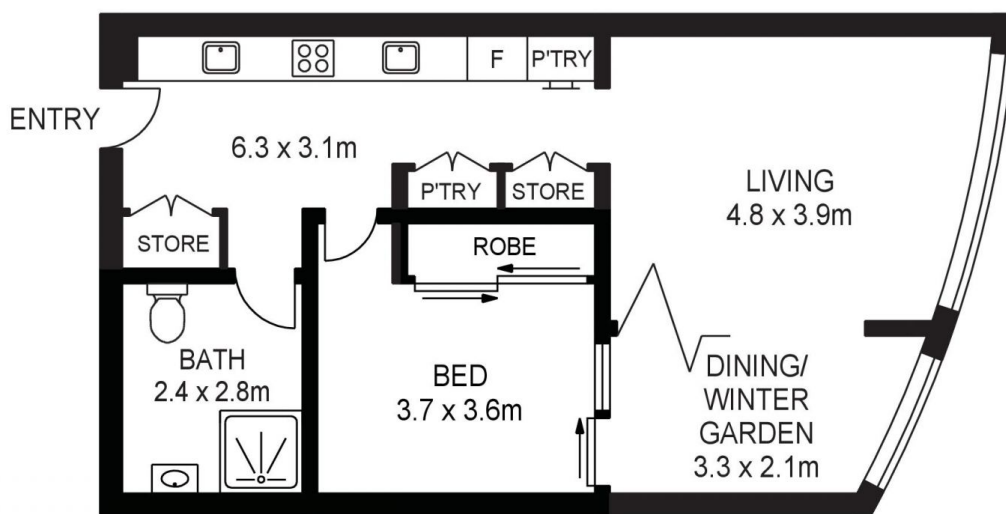
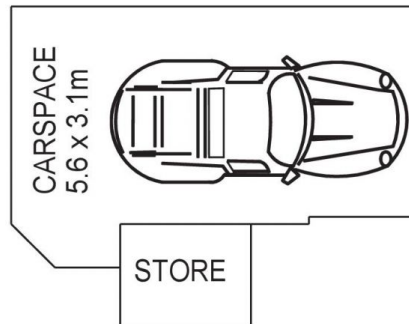

FOURTEENTH LEVEL

APPROX. INT. AREA : 66m²

APPROX. EXT AREA : 16m²

1402/ 2 WATERWAYS ST, WENTWORTH POINT



ASSET
PHOTOGRAPHERS

www.assetphotographers.com.au

Please note these measurements are approximate only.
The plans are intended as a rough guide for illustrative
purposes. It is not warranted or guaranteed to be correct
nor is it a part of the sale or rental contract.

