



morton.

Riverwood 421/7 Washington Avenue

 2  2  1

With respect to the government's restrictions around open homes and to help stop the spread of COVID-19, our properties can be viewed by appointment only. Please submit an online enquiry or contact the listing agent for more information.

Located in Como complex within the new urban hub of Washington Park, this fantastic apartment - in a master planned community - offers new lifestyle living in a beautiful, quiet and upcoming location.

- Large open plan living/dining, opens onto balcony
- Modern galley style kitchen with mirror splash back
- Offers stainless steel Omega appliances & gas cooktop
- Large double bedrooms including built-in wardrobe
- Master bed with ensuite & bathtub
- Separate study area & internal laundry
- Air conditioning
- Secure car space

View

As advertised or by appointment

Agent

Lisa Xi

 0401 311 667

 lisa@morton.com.au

morton.com.au



**APARTMENT 421
LOT 177
2 BED + STUDY**

Internal	78sqm
External	7sqm
Total	85sqm

COMO

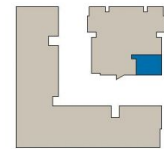

1300 111 088
www.washingtonpark.com.au

Proudly developed by
PAYCE

Disclaimer: This floor plan has been prepared for marketing purposes only. All descriptions, dimensions, depictions and other details in this floor plan may not be to scale and may vary from the property as built. Your attention is drawn to the special conditions of the contract for sale of land. No third party has any authority to make or give any representation or warranty in relation to the property unless the representation or warranty is confirmed by Payce Communities No.1 Pty Limited and included in the contract for sale of land. [Rev A 13.05.13]



**We are
Washington Park.**