



# morton.

**Pyrmont** 1405/243 Pyrmont Street

 2  2  1

With respect to the government's restrictions around open homes and to help stop the spread of COVID-19, our properties may be viewed by appointment only and only 1 person may inspect at a time. Please submit an online enquiry or contact the listing agent for more information.

Well designed to provide a unique modern living space in a superb inner-city location, this single level penthouse is the perfect home for those who like to live and entertain in easy style. It commands a stunning panorama that stretches over the city skyline and surrounds, plus it has been laid out to provide a premium urban living experience complete with its own private 107 sqm outdoor terrace.

- On the top floor of the landmark 'Goldsbrough' complex
- Light and airy design with designated lounge and dining
- Breathtaking alternate views of city skyline & Blackwattle Bay

- An expansive 107 terrace with private outdoor Jacuzzi and BBQ area

[morton.com.au](https://www.morton.com.au)

### View

As advertised or by appointment

### Agent

**Nicole Beckett**

 0409 896 152

 [nicole@morton.com.au](mailto:nicole@morton.com.au)

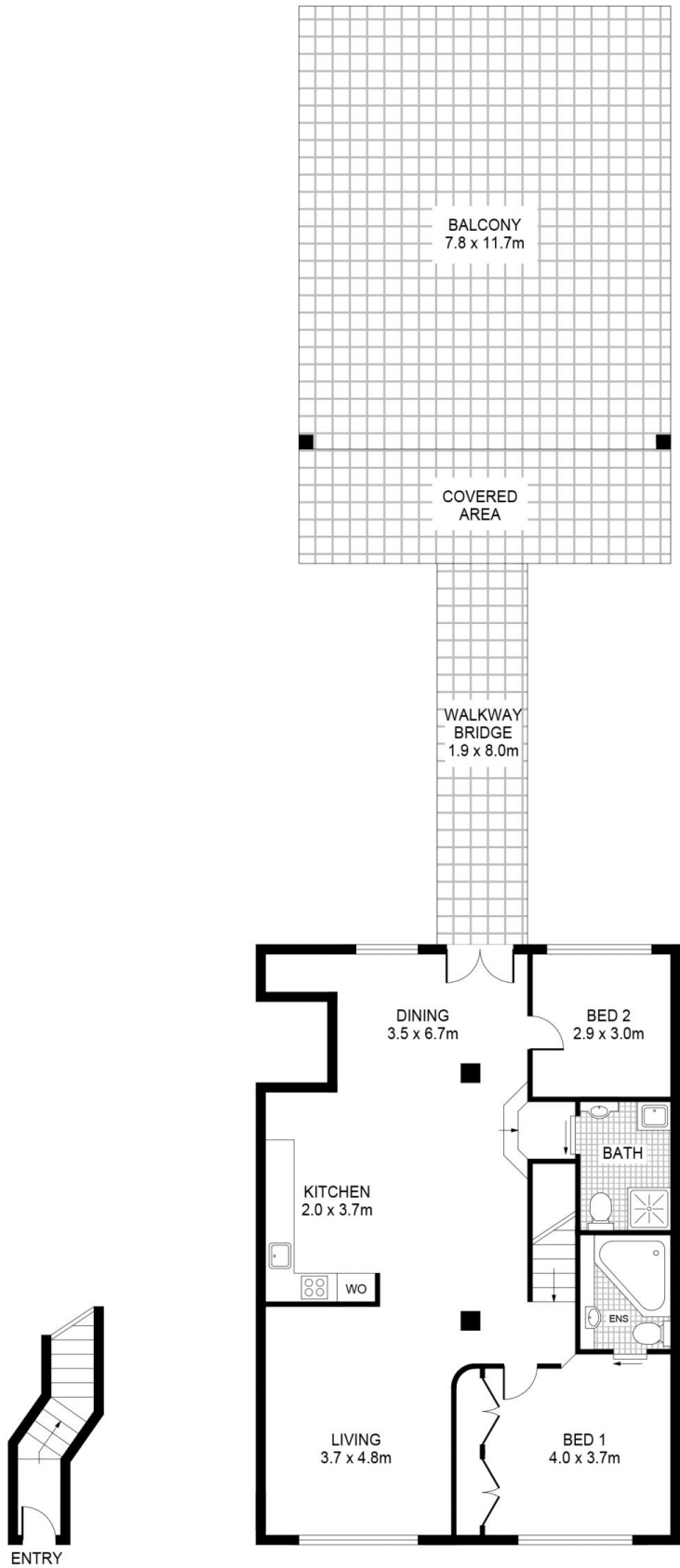

PLANS SHOWN ONLY INDICATIVE OF LAYOUT. DIMENSIONS ARE APPROXIMATE.

