



morton.

Sydney 340/298 Sussex Street



Highly sought after one bedroom with secure lock up garage style parking and storage in the heart of the Sydney CBD. Situated in the Maestri Towers complex renowned for its close proximity to Town Hall, Chinatown, Darling Quarter, and Darling Harbour. Freshly updated with open plan living comprising of a combined lounge/dining opening to a tiled balcony, a generous bedroom with a built-in robe, a full modern bathroom, and an internal laundry

- Contemporary kitchen, gas cooking, and dishwasher
- Wooden Flooring throughout
- Ducted air-conditioning, internal laundry with dryer
- Full-sized bathroom, separate bathtub, and shower
- Direct lift access to secure basement level car space garage.
- Facilities, heated swimming pool, sauna, and gym
- Security building, onsite management, and security
- Walking distance to Sydney CBD and Darling Harbour

Placed in a renowned security building no more than moments to the boutique shopping of the Queen Victoria Building, cafes,

morton.com.au

View

As advertised or by appointment

Agents

Ettiene West

📞 0410 593 749
✉️ ettiene@morton.com.au

Emma Ryan

📞 0409 325 440
✉️ emmar@morton.com.au

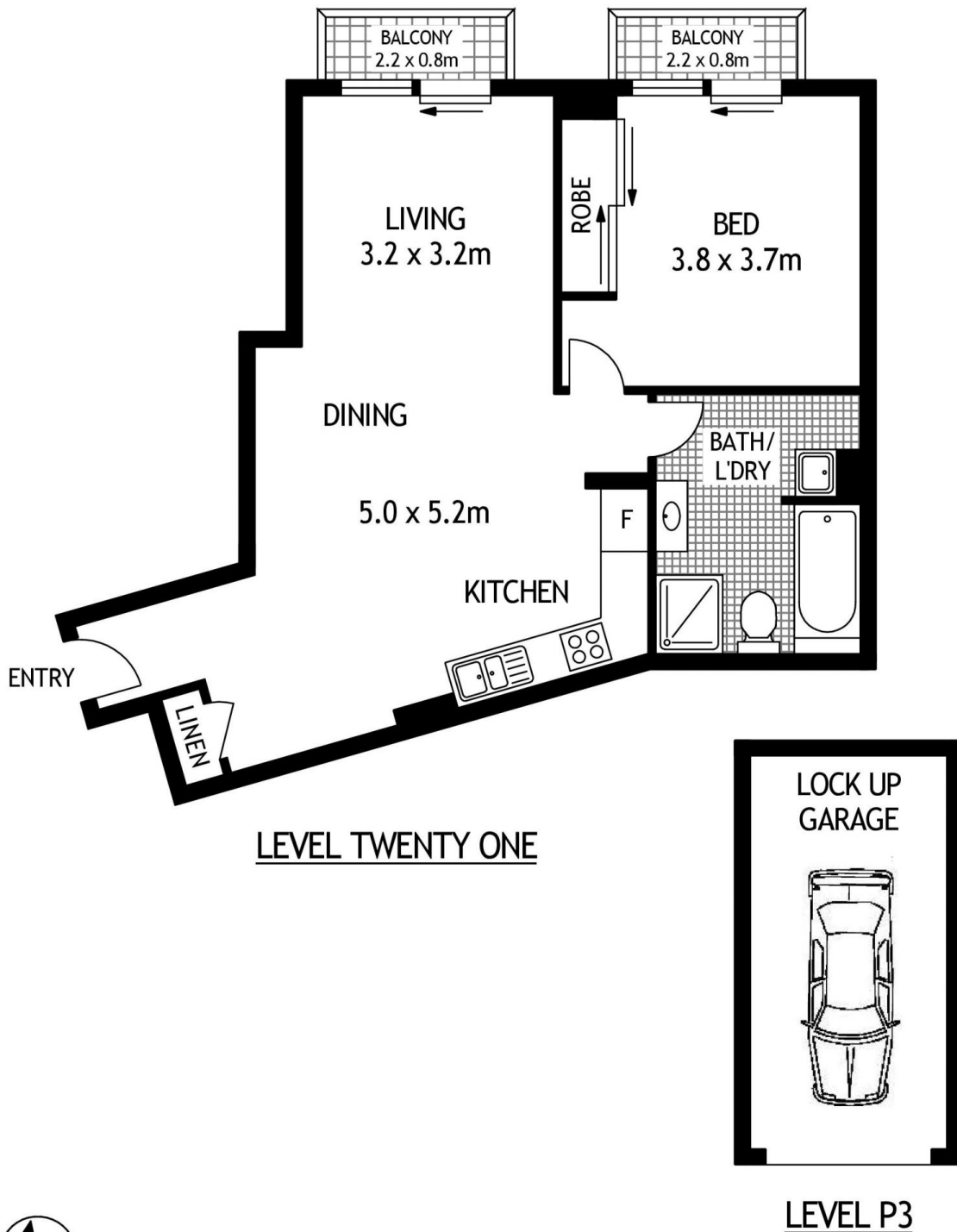

340/298 SUSSEX STREET

SYDNEY

SCAPE Floor Planing Disclaimer: This floor plan is conceptual only. it is provided for illustrative purposes only and should not be relied upon. We make no guarantees to the correctness of this plan. All interested parties should make and rely on their own enquiries in determining the accuracy of the information contained in this floor plan.