



**morton.**

**Ermington** 9/2 Fitzgerald Road

 3  2  1

With respect to the government's restrictions around open homes and to help stop the spread of COVID-19, our properties may be viewed by appointment only and only 1 person may inspect at a time. Please submit an online enquiry or contact the listing agent for more information.

Within easy access to CBD, only minutes to Eastwood Shopping Village, CBD Ryde, Parramatta buses, CBD transport and local eateries this stylish townhouse is effortlessly convenient and peacefully set. With its east-west aspect, its living area and bedrooms spanning a generous split-level layout are afforded all-day natural light. The modern kitchen overlooks a private all-seasons alfresco courtyard, with a practical garden shed in-built for you, close to tennis court and outdoor gym in local park. In the catchment of opportunity class in Ermington Public School and Marsden High School.

- Fresh neutral tones and low maintenance
- Tiled open plan dining flowing to alfresco courtyard

**View**

As advertised or by appointment

**Agent**

**Sarah Fowell**

 0437 492 129

 [rentals@morton.com.au](mailto:rentals@morton.com.au)

**[morton.com.au](http://morton.com.au)**

9 / 2 Fitzgerald Road,  
Ermington



First Floor

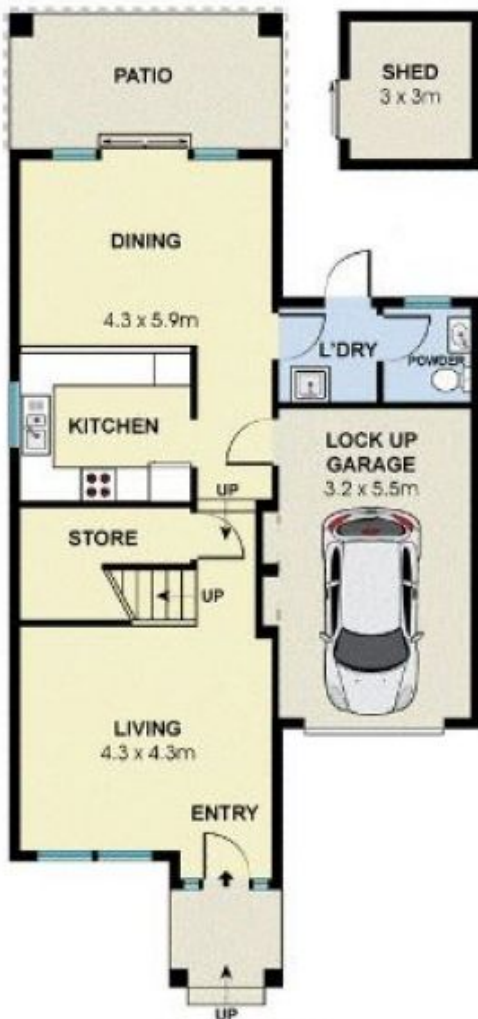

Ground Floor



Site Plan



Scale in metres. Indicative only. Dimensions are approximate. All information contained here in is gathered from sources we believe to be reliable. However we cannot guarantee its accuracy and interested persons should rely on their own enquiries